



**Islamic Relief Kenya**

TENDER DOCUMENT FOR

**CONSTRUCTION OF FIVE CLASSROOMS AND FOUR 2-DOOR VIP LATRINES  
(TOTAL OF EIGHT DOORS) AT ADELE PRIMARY SCHOOL, TANA RIVER COUNTY.**

REF NO: IRK/TNR/LDP/WORKS/002/01/2025

ISSUED ON: Tuesday, January 7, 2025

CLOSING DATE: Tuesday, January 21, 2025, 11:00 AM

NAME AND CONTACT OF PROCURING ENTITY:

Islamic Relief Kenya  
Kirichwa Road, off Ngong Road  
P.O.BOX 417 – 00202 KNH, Nairobi  
Email: [procurement.Irk@islamic-relief.or.ke](mailto:procurement.Irk@islamic-relief.or.ke)

## **INSTRUCTION TO BIDDERS**

Established in 1984 in the UK, Islamic Relief is an international NGO seeking to promote sustainable economic and social development by working with local communities through relief and development activities regardless of race, color and religion, and without expecting anything in return.

IR started operations in Kenya in 1993 on orphan's sponsorship programme through a local CBO in Mandera District, Northern Kenya. It opened its fully fledged office in March in 2006 at the height of drought in the Horn of Africa. Since then, IR has been providing humanitarian and development assistance to vulnerable communities. Over these years it has implemented various development and relief activities in Mandera. This has remarkably changed the lives of the vulnerable and disadvantaged communities. In January 2010, IRK extended its operation to Wajir County and in January 2012 expanded to Garissa and Dadaab, and in October 2017 opened a programme office in Kilifi County.

Islamic Relief Kenya focuses on resilience projects namely: Food Security and Livelihoods, Water Sanitation and Hygiene, Cash Transfer Programming, Orphans Support and Sponsorship, women Empowerment, Education and Peace-building.

The WAVE project is under implementation in Tana River County Kenya. It aims to implement inclusive climate adaptation and resilience actions and strategies at grass root levels to increase the adaptive capacity and level of climate resilience of the target communities, the project outcomes are,

1. Increased access to potable and sufficient water for human and livestock consumption and for small-scale irrigation.
2. Improved agricultural and livestock productivity through supporting extension services and climate smart agricultural practices, for optimal food production.
3. Increased income and asset growth for the unemployed urban, and peri urban youths.
4. Strengthened community managed disaster risk reduction capacity.

In order to achieve this, IRK is raising this tender document for **Construction of Five Classrooms and Four 2-Door VIP Latrines (Total of Eight Doors) at Adele Primary School, Tana River County.**

Islamic Relief Kenya website: <https://islamic-relief.or.ke>. Complete one tender document in pdf format (max 25mb) with subject as tender name and reference number to be submitted via email [tenders@islamic-relief.or.ke](mailto:tenders@islamic-relief.or.ke) no later than **January 21, 2025 at 11:00 am**

A complete set of tender documents may be obtained Free of Charge by interested candidates by downloading from the link provided: Islamic Relief Kenya website: <https://islamic-relief.or.ke>

### **Bid Submission Requirements**

Interested bidders are advised to read the submission instructions carefully to ensure compliance

**Submission Email:** To be submitted via email: [tenders@islamic-relief.or.ke](mailto:tenders@islamic-relief.or.ke)

**Single PDF Document:** Each bid must be submitted as a single, consolidated PDF document (Max 25mb). Multiple or fragmented submissions will not be accepted.

**Bidder Email:** Interested bidders may submit their bids **ONLY** from the official email address of the bidder or company

**Direct PDF Attachment Only:** Bid documents must be attached directly as PDF files in the submission email. Links to external file-sharing platforms, such as Google Drive or Dropbox, are not permitted and will not be reviewed.

**Subject Line Specification:** Bidders must include the tender name and reference number in the email subject line to ensure proper filtering and identification of submissions.

**Disqualification Notice:** Failure to adhere to these submission requirements will result in the disqualification of the bid.

**Tender Name:** Construction of Five Classrooms and Four 2-Door VIP Latrines (Total of Eight Doors) at Adele Primary School, Tana River County.

**Tender Ref No:** IRK/TNR/LDP/WORKS/002/01/2025

**Submission Deadline:** **Tuesday, January 21, 2025**

Tenders will be opened immediately thereafter in the presence of bidders or their representatives who choose to attend in the Islamic Relief Boardroom. Any tender documents received later than the deadline will not be accepted.

At the tender opening, IRK will announce the tender's names, total tender price, and such other details as the Employer, at his discretion, may consider appropriate. No tender shall be rejected at the tender opening except for late tenders. Tenders not opened and read out at the tender opening shall not be considered further for evaluation, irrespective of the circumstances.

Prices quoted should be inclusive of all taxes, must be in Kenya shillings and shall remain valid for (60) days from the closing date of tender.

At the tender opening, IRK will announce the tenderer's names, total tender price, and such other details as the Employer, at his discretion, may consider appropriate. No tender shall be rejected at the tender opening except for late tenders. Tenders not opened and read out at the tender opening shall not be considered further for evaluation, irrespective of the circumstances.

## **INSTRUCTION TO BIDDERS**

**PROCURING ENTITY:** ISLAMIC RELIEF KENYA. P.O BOX 417-00202 KNH, Nairobi

CONSTRUCTION OF FIVE CLASSROOMS AND FOUR 2-DOOR VIP LATRINES (TOTAL OF EIGHT DOORS) AT ADELE PRIMARY SCHOOL, TANA RIVER COUNTY.

1. All Tenders above must be accompanied by a Bid Bond at least 10% of the quoted amount valid for 180 days.
2. **Only** tenders submitted electronically will be accepted. Late tenders will be rejected

### **3. Work Scope and Sites Details**

The tender is for undertaking the following components as per Annex I – BoQ and Annex II – Drawings: Construction of Five Classrooms and Four 2-Door VIP Latrines (Total of Eight Doors) at Adele Primary School, Tana River County.

### **Eligible Bidders**

The invitation for the bids is open to all interested eligible Companies/individuals who are duly registered with the national government, respective County governments and National construction authority.

### **4. Services**

All services to be done under the contract shall have their measurement and shall not be subcontracted.

### **5. Cost of Bidding**

The bidders shall bear all costs associated with preparation and submission of its bid & IRK will in no case be responsible for those costs, regardless of the conduct or outcome of the bidding process.

### **6. Clarification of Bidding Documents**

Interested eligible candidates who may want to obtain further information or seek for clarification can do so by sending an email to [Procurement.Irk@islamic-relief.or.ke](mailto:Procurement.Irk@islamic-relief.or.ke) OR +254 727531220 / 2543861216. IRK will respond in writing to any request prior to the deadline.

If you have any concerns – relating to this tender or otherwise – or want to make a complaint please:

Call us on +254 700 200 849

Email us at: [complaints@irworldwide.org](mailto:complaints@irworldwide.org)

## 7. Amendment of Bidding documents

At any time prior to the deadline for submission of bids, IRK May for any reason, at its own initiative or in response to a clarification requested by a prospective bidder, modify the bidding documents & will be binding on them. The amendment will be notified in writing to all prospective bidders, who have received the bidding documents & will be binding on them. In order to allow prospective bidders responsive time in which to take the amendment into account in preparing their bids, IRK may, at its discretion, extend the deadline for bid submission.

## 8. Language of the Bid

The bid prepared by the bidder, as well as all correspondence & documents relating to the bid, supporting documents and printed literature furnished by the bidder shall be written in English language.

## 9. Bid Document Comprises.

The bid document prepared by the bidder shall comprise of the following:

- a) Each page of the tender document serialized.
- b) Form of tender signed and stamped by the authorized person.
- c) Tender submitted with tender security as required (bid bond 10% of the quoted amount)
- d) Completed and signed confidential business questionnaire form.
- e) Certified Copy of Certificate of Incorporation/Registration.
- f) Disclosure of business ownership (Directors/ Partners /Sole Proprietor). Attach a copy of CR12 Form
- g) Certified Copy of Current Tax Compliance certificate from Kenya Revenue Authority – must verifiable online –itax
- h) KRA PIN with VAT obligation
- i) Certified Copy of Valid and current Business Permit
- j) Certified copy of Valid registration for National Construction Authority NCA 7 and above – water and building works
- k) Bidder to provide self-declaration that the person/tenderer will not engage in any corrupt or fraudulent practice.
- l) Only certified Statement of comprehensive income for the last three years (Max. 3 pages) signed by auditors.
- m) Company Profile with brief business description, physical location, address and company structure (Max. 5 pages).
- n) Evidence of Past Experience in Similar work done for the last 5 years e.g. at least 5 signed contracts supported by LPO and Certificate of completion
- o) Copy of ID/Passport for Company Owner/Director
- p) Bid bond (10% of the quoted amounts)
- q) Key Technical staff and their CVs (Key people but not more than four CVs)
- r) List of Key Equipment (**only** relevant equipment).
- s) Detailed workplan and methodology statement: Work plan demonstrating flow of work from inception to site hand over) (Max 3 pages)
- t) Bank Statement for 6 months (1st June 2024 – 30<sup>th</sup> November 2024)
- u) Duly filled Tender B.o.Q and forms in the format provided
- v) All copies of certified/mandatory documents must be Certified by a Commissioner of Notary/ Oath.

**NB:** - *Partial delivery of the documents will lead to disqualification. Preference shall be given to qualified local supplier with valid licenses.*

- *It is advisable that the bidder at own cost and convenience to undertake a physical visit and assessment of the particular site for the proposed works prior to the compilation of the bid.*

## **10. Bid Currencies**

The bids prices shall be quoted in Kenya Shillings (KES).

## **11. Bids Prices**

- The potential contractor shall submit his/her bid in the BOQ format provided in Annex I
- The bidders shall indicate the unit price where possible and the total bid price as indicated in the BOQ.
- Prices quoted by the bidder shall be fixed during the performance of the contract.

## **12. Withholding Tax**

IRK shall retain 3% of contract value as withholding tax and remit to the government. A receipt shall be issued for this.

## **13. Retainer**

IRK shall retain 10% of the contract value for a period of 6 months being defect liability.

## **14. IRK's right to vary quantities at the time of the award**

IRK reserve the right at the time of award of contract to increase or decrease by up to 10% the quantity of work specified in the technical specification without change of unit price or other terms of condition.

## **15. IRK's right to accept any bid and/or reject any or all bids**

IRK reserves the right to accept any bid and to annul the bidding processes and reject all bids at any time prior to award of contract, without, thereby incurring any liability to the affected bidder or bidders or any obligation to inform the affected bidder or bidders on the grounds of its action.

## **16. Submission of Bids**

The bidders shall submit their bids in one envelope marked with Tender Name and Reference.

## **17. Evaluation**

18.1 IRK will examine the prequalification documents to determine completeness, general orderliness, sufficiency in responsiveness, price and product brand.

18.2 The potential contractor shall not contact IRK on matters relating to their bid from the time of opening to completion and official communication sent to them. Any effort by the potential contractor to influence IRK in the evaluation shall result in disqualification.

18.3 Prequalification will be based on meeting the minimum criteria regarding the applicant's legal status, general and experience, personnel and financial position as demonstrated by their responses as set in clause

18.4 The applicants **MUST** have registered offices and IRK reserves the discretion of visiting physical premises from which the applicant conducts business if so desired to confirm existence and capability to execute the contract.

18.5 Due diligence shall be undertaken, and any bidder found to be in breach by providing false information shall be disqualified.

## **19. Employment of Minors**

The Contractor shall not employ children in executing the contract. The Contractor shall observe international conventions relating to child labor namely the UN Convention No.182 on worst forms of child labor and convention No. 138 on the minimum age for admission to employment.

## 20. Criminal Act

The Contractor undertakes to comply with all applicable laws and to ensure that it does not engage in any kind of criminal activity including but not limited to bribery, fraud, corruption, terrorism and to maintain ethical business practices as well as not to commit any Prohibited Acts defined as: -

- i) To offer, promise or give any person a financial or other advantage.
- ii) To request, agree to receive or accept any financial or other advantage not expressly provided for as an inducement or a reward for the performance of any function or activity in connection with this Agreement.

### BID EVALUATION RATING SCALE

#### **MANDATORY REQUIREMENTS**

No	Description	Mandatory Evaluation (YES/NO)
1	Company Registration Certificate – Mandatory	
2	CR12- issued within the last 3 months	
3	Duly filled forms (Organization details, Grounds for Mandatory Rejection, Grounds for Discretionary rejection form, Bid Value, Financial and declaration)	
4.	Valid Registration with the county government/valid and genuine business permit.	
5.	Valid Registration with (NCA7 and above). ( building Works)	
7	Active KRA PIN – With VAT Obligation	
8	Valid Tax Compliance	
9	Copy of ID/ Passport of the directors	
10	Serialization of the Bid – Bidders shall sequentially serialize all pages of the	

**Note:** Bids that do not include any of the documents listed as mandatory will not be considered for either the technical or financial evaluation.

#### **TECHNICAL ANALYSIS**

No.	Description	Score
1	Brief Company Profile with verifiable physical location/address	10
2	List of Key Equipment	Owned (Max 15 marks)
		50% Owned – 50% leased (Max - 7)
		100% leased (Max. 5 Marks)
3	List of Key Personnel	(Degrees- 10, HNDs – 6, Diplomas – 4)
4	Number of Years in Operation at least 5 years	1yr - 2 marks 2yrs- 4 marks 3yrs- 6 marks 4yrs- 8 marks 5yrs & above – 10 marks
5	Evidence of past similar works – Contract, LPO & Completion certificates.	-5 or More = (Max. 30 marks)
		4 LPOs, contracts & completion cert. (Max 24 marks)
		3 LPOs, contracts & completion cert. (Max 18 marks)

		2 LPOs, contracts & completion cert. (Max 12)	
		1 LPO/contracts/completion cert (Max 4 Marks) Note: the contract/LPOs/completion certificate must be readable, signed and stamped by the issuing authority for authentication.	
<b>6</b>	Detailed work plan and methodology statement	Detailed workplan and methodology statement: Work plan demonstrating flow of work from inception to site hand over) (Max 3 pages)	10
	<b>TOTAL</b>	<b>100</b>	

Note: Bids that do not score 80% or above in the technical analysis will be automatically disqualified and will not be considered for financial evaluation.

#### **FINANCIAL ANALYSIS**

<b>No.</b>	<b>Description</b>		<b>Maximum</b>
<b>1</b>	Certified Bank statement for the past six months.	Certified bank statement for 6 months.	25
<b>2</b>	Evidence of Certified letter of credit from the reputable from reputable bank.	Certified letter (signed & stamped) of credit.	25
	<b>TOTAL</b>		<b>50</b>

Note: Bids that do not score 75% or above in the financial analysis shall not be considered for due diligence.

#### **Tender Schedule**

<b>Task</b>	<b>Tentative Tender Schedule</b>
Advertising of tender	Tuesday January 7, 2025
Closing of tender	Tuesday, January 21, 2025, 11:00 am
Opening of tender	Tuesday, January 21, 2025, 11:00 am
Evaluation	January 22 <sup>nd</sup> – 24 <sup>th</sup> 2025
Award	January 27 <sup>th</sup> – January 30 <sup>th</sup> 2025



# MANDATORY QUESTIONNAIRE

## A: Organization and Contact Details

<b><u>Full Name of Organization</u></b>			
<b><u>Date of Registration</u></b>			
<b>Registration Certificate Number</b>			
<b>Street</b>		<b>Road</b>	
<b>Address</b>		<b>Code</b>	
<b>Town</b>			
<b>Email</b>		<b>Telephone No.</b>	
<b>PIN No.</b>			
<b>Name of Parent Company</b>			
<b>Type of Organization</b>	A Public Limited Company		
	A Limited Company		
	A Limited Liability Partnership		
	Other Partnership		
	Sole Trader		
	Other (Please Specify)		

### Name of Owners

<b>Name</b>	<b>ID/Passport No.</b>	<b>Nationality</b>

### **DETAILS FOR CONTACT PERSON**

Contact details for enquiries about this PQQ/Business Issues

<b>Name of Staff</b>	
<b>Address</b>	
<b>Post Code</b>	
<b>Town</b>	
<b>Phone</b>	
<b>Mobile</b>	
<b>Email</b>	

## B - Grounds for Mandatory Rejection

### Important Notice:

In some circumstances IRK is required by law to exclude you from participating further in a procurement. If you cannot answer 'no' to every question in this section it is very unlikely that your application will be accepted, and you should contact us for advice before completing this form.

Please state 'Yes' or 'No' to each question.

<b>Has your organization or any directors or partner or any other person who has powers of representation, decision or control been convicted of <u>any of the following offences?</u></b>	<b>Answer</b>
(a) A crime	
(b) Corruption	
(c) The offence of bribery;	
(d) Fraud within the meaning of:	
i) Money laundering	
ii) Any other offence	

Has your organization fulfilled obligations related to the payment of social security contributions or the payment of taxes in accordance with the legal? Answer with a "Yes" or "No"	
---	--

## C - Grounds for Discretionary Rejection

### Important Notice:

IRK is entitled to exclude you from consideration if any of the following apply but may decide to allow you to proceed further. If you cannot answer 'no' to every question it is possible that your application might not be accepted. In the event that any of the following do apply, please set out (in a separate Annex) full details of the relevant incident and any remedial action taken subsequently. The information provided will be taken into account by IRK in considering whether or not you will be able to proceed any further in respect of this procurement exercise. Please state 'Yes' or 'No' to each question.

<b><u>Is any of the following true of your organization?</u></b>	
(a) <u>Is bankrupt</u> or under receivership or bankruptcy restrictions order made against the organization	
(b) <u>Is insolvent</u> ,	
(c) <u>Is</u> the subject of an order by the court winding up otherwise than for the purpose of bona fide reconstruction or amalgamation, or had a receiver, manager or administrator on behalf of a creditor appointed in respect of the company's business or any part thereof or is the subject of similar procedures under the law of any other state?	
<b><u>Has your organization</u></b>	
(a) been convicted of a criminal offence relating to the conduct of your business or profession;	
(b) committed an act of grave misconduct in the course of your business or profession;	
(c) failed to fulfil obligations relating to the payment of social security contributions	
(d) failed to fulfil obligations relating to the payment of taxes under the	

(e) been guilty of serious misrepresentation in providing any information required	
--	--

### D – Bid Value & Duration of Supply

<i>Bid Value for the Work</i>	<i>Kshs.</i> _____
<i>Payment Terms</i>	
<i>Duration of Delivery</i>	
<i>Remarks</i>	

### E - Financial

<b>1</b>	<b>BANK INFORMATION</b>	
1.1	<i>Bank</i>	
	<i>Branch</i>	
	<i>Account Name</i>	
	<i>Account Number</i>	
	<i>Swift Code</i>	
	<i>Letter From Bank Confirming Account &amp; Credit Facility</i>	

### F Declaration Declaration

2.	<p>I declare that to the best of my knowledge the answers submitted in this bid document are correct. I understand that the information will be used in the process to assess my organization's suitability to be invited to tender for Islamic Relief's requirement and I am signing on behalf of my organization. I understand that the Contracting Authority may reject this bid if there is a failure to answer all relevant questions fully or if I provide false/misleading information. By signing the bid document, I certify that all of the above statements are accurate and factual.</p> <p style="text-align: center;"><b>FORM COMPLETED BY</b></p>	
2.1	Name:	
2.2	Position:	
2.3	Signature:	
2.4	Date:	

2.5	Stamp:	
-----	--------	--

Name of Bidder: \_\_\_\_\_

Authorized signature: \_\_\_\_\_

Name of Authorized signatory: \_\_\_\_\_

Functional Title: \_\_\_\_\_

Telephone Number: \_\_\_\_\_

Email Address: \_\_\_\_\_

Date: \_\_\_/\_\_\_/2024

Official Stamp:

## ANNEX I: B.O.Q

<b>PROPOSED 5 CLASSROOM BLOCK AT ADELE PRIMARY SCHOOL-TANA RIVER</b>					
Item	Description	Qty	Unit	Rate	Kshs
	-				
	<b><u>ELEMENT NO. 1:</u></b> <b><u>SUBSTRUCTURE (PROVISIONAL)</u></b>				
A	Clear site off all vegetation including small trees, scrubs and bushes	400	SM		
	<b><u>EARTHWORKS</u></b>				
	-				
B	Excavate to remove top vegetable soil and heap as directed on site; average depth of 200mm	93	CM		
C	Excavate foundation trenches commencing from reduced level: not exceeding 1.5 m deep	178	CM		
D	Return, fill and ram selected soil in foundations	178	CM		
E	Remove surplus spoil from site to a location approved by the owner	95	CM		
F	Extra over all excavations and earthworks for breaking up rock at any point	50	CM		
	<b><u>CONCRETE</u></b>				
	<u>Plain concrete class 15/40 :in</u>				
H	50 mm Thick blinding to strip foundations	10.0	CM		
	Carried to Collection				

	<u>Reinforced concrete class 20/20: vibrated: in.</u>				
A	Strip foundations	10.0	CM		
B	125 mm thick floor bed	40	CM		
	<b><u>Reinforcement</u></b>				
	-				
	<u>Mild steel reinforcement bars: hot rolled: to BS 4449: including bends, hooks, tying wire, distance blocks and spacers</u>				
	-				
F	8 mm Bars	550	KG		
	<u>High tensile, square twisted bar reinforcement to BS 4461</u>				
	-				
H	12 mm Bars	600	KG		
	Carried to Collection				
A	Mesh reinforcement No. A142 weighing 2.22 kg per square metre: in floor slab: including all necessary supports: allow for laps and bonding to existing slabs	270	SM		
	<u>Sawn formwork: to</u>				
B	Sides: strip foundation	75	SM		
C	Edges of surface bed: over 75 mm but not exceeding 150mm girth	100	LM		
	<b><u>Walls</u></b>				
F	200 mm Thick natural local stone foundation walls: bedded and jointed in cement and sand (1:4) mortar	115	SM		
	<b><u>Hardcore</u></b>				
	-				
G	300mm thick Hardcore of approved inert material: well watered and compacted in 150 mm thick (max) layers	115	CM		
	<b><u>Murram Fill</u></b>				

H	Selected murrum fill; imported; well watered and compacted in 50 mm thick (max) layers	19	CM		
	Carried to Collection				
	<b><u>Anti-termite Treatment</u></b>				
	-				
A	Dragnet FT' anti-termite chemical treatment: applied by Insecta ltd. or other approved professional pest control specialist: applied strictly in accordance with the manufacturer's instructions: 10 year guarantee	263	SM		
	<b><u>Blinding</u></b>				
	-				
B	50 mm Thick approved quality quarry dust blinding to surfaces of hardcore	263	SM		
	<b><u>DPM</u></b>				
	-				
C	Gauge 1000 polythene damp proof membrane	263	SM		
	<b><u>Plinth Finishes</u></b>				
	-				
	<u>25 mm Thick cement and sand (1:4) rendering: on concrete or stonework: wood float finished: to</u>				
	-				
D	Plinths: externally	56	SM		
	<u>Prepare surfaces and apply undercoat and two finishing coats black bitumastic or other equal approved water resistant paint: on rendered surfaces: to</u>				
E	Plinths: externally	56	SM		
	Carried to Collection				
	<b><u>Collection</u></b>				
	From page 1				
	From page 2				

	From page 3				
<b>TOTAL FOR SUBSTRUCTURE CARRIED TO BUILDERS WORK SUMMARY</b>					
<b><u>ELEMENT NO. 2: WALLING</u></b>					
<b><u>EXTERNAL WALLS</u></b>					
-					
<u>Natural stone walls as local approved stone: medium chisel dressed both sides: bedded, jointed and pointed in cement sand (1:3) mortar: flush vertical and horizontal joints :in</u>					
-					
A	200 mm Thick walls	160	Sm		
B	Ditto 200 mm Thick gable walls	27	Sm		
<u>Horizontal bituminous hessian base to BS 743 type A: or other equal approved damp-proof course: in cement/ sand (1:3) mortar: to</u>					
-					
C	200 mm Wide: under walling	96	Lm		
<b><u>INTERNAL WALLS</u></b>					
-					
<u>Natural stone walls as local approved stone: medium chisel dressed both sides: bedded, jointed and pointed in cement sand (1:3) mortar: flush vertical and horizontal joints :in</u>					
-					
D	200 mm Thick : ditto	69	Sm		
<u>Approved expansion joint filler</u>					
-					
G	Joint filler	27	Lm		
Carried to Collection					
<u>Bituminous hessian base to BS 743 type A: or other equal approved damp-proof course: in cement/ sand (1:3) mortar</u>					
-					
A	200 mm wide	37	Lm		
B	150 mm wide	37	Lm		
Carried to Collection					
<b><u>Collection</u></b>					



	From page 6				
	From page 7				
<b>TOTAL FOR WALLING CARRIED TO BUILDERS WORK SUMMARY</b>					
<b><u>ELEMENT NO. 3:</u></b>					
<b><u>SUPERSTRUCTURE CONCRETE</u></b>					
	<u>In situ reinforced concrete class 20 /20:</u> <u>vibrated: in</u>				
	-				
A	300mm x 200mm Ring Beams	9.3	Cm		
<b>Steel reinforcement</b>					
	-				
	<u>Mild steel reinforcement bars: hot</u> <u>rolled: to BS 4449: including bends,</u> <u>hooks, tying wire, distance blocks and</u> <u>spacers</u>				
	-				
B	8 mm Bars	220	Kg		
	<u>High yield square twisted steel bar</u> <u>reinforcement to BS 4461 and KS 02-</u> <u>22:1976: including bends, hooks, tying</u> <u>wire, distance blocks and spacers</u>				
	-				
C	12 mm Bars	490	Kg		
	<u>Sawn formwork: to</u>				
D	Sides and soffits: beams	120	Sm		
E	75mm steel pole complete with foundation and connections to the wall plate	40	Lm		
<b>TOTAL FOR SUPERSTRUCTURE CARRIED TO BUILDERS WORK SUMMARY</b>					
<b><u>ELEMENT NO. 4: ROOF</u></b>					
	-				
<b><u>ROOF STRUCTURE</u></b>					
	-				
	<u>Sawn cypress: second grade: clean:</u> <u>pre-treated with wood preservative to</u>				

	<u>engineers approval: including jointing and connections as necessary</u>				
	-				
A	50 x 150 mm Rafter: in trusses	295	Lm		
	-				
B	150 x 50 mm: tie beam and timber members	560	Lm		
	-				
C	100 x 50 mm: Struts and ties	400	Lm		
	-				
D	200 x 25mm ridge piece	90	Lm		
	-				
E	75 x 50mm purlins (over and under)	560	Lm		
	-				
F	100 x 50 mm Wall plate: fixed to concrete with approved bolts at 1000 mm centres	114	Lm		
	-				
G	MS cleat plate 50 x 175 x 100mm - 4mm thick	90	No.		
	-				
H	12mm diameter high density anchor bolt 200mm long built into beam: including nut and washer	90	No.		
	-				
I	10mm diameter bolts with washers bolted at the tie members into the roof truss	55	No.		
	-				
	<b><u>ROOF COVERING</u></b>				
	-				
	<u>Gauge 28 pre painted ordinary sheets or any other approved on 50x50mm timber purlins; on 150x50mm rafters, struts, tie beam on wall plate</u>				
	-				
J	Roof covering	426	Sm		
	-				
K	Ridge/hip cap to match	40	Lm		
	-				
	Carried to collection				
	<b><u>Rainwater goods</u></b>				
	-				
	<u>Galvanised iron metal sheet: gauge 24: pre-painted</u>				
	-				
A	150x150mm Box gutter: fixed to fascia with and including steel flat brackets at 1500 mm (maximum) centres: holes for down pipes as necessary: closed ends	60	Lm		
	-				

B	150 x 150 mm square section rain water downpipe: holderbats at 1500 mm (maximum) centres (4No. pipes)	30	Lm		
C	Extra over ditto for 800 mm swan neck offset	4	No		
D	Ditto for shoe	4	No		
	<u>PVC to the eaves:</u>				
E	PVC vista t&g: over mosquito net: nailed on and including 50 x 50 mm bearers	40	Sm		
	<u>Wrot cypress</u>				
F	225 x 25 mm Fascia board	100	Lm		
G	Ditto: barge board	100	Lm		
	<u>Prepare surfaces: and apply undercoat and two finishing coats first grade gloss enamel paint as "Crown Paints" or other equal approved: on wooden surfaces: to</u>				
H	Fascia and barge boards: surfaces over 200 but not exceeding 300 mm girth	200	Lm		
	Carried to collection				
	<b><u>Collection</u></b>				
	From page 10				
	From page 11				
<b>TOTAL FOR ROOF CARRIED TO BUILDERS WORK SUMMARY</b>					
<b><u>ELEMENT NO. 5: DOORS</u></b>					
<b><u>-</u></b>					
<b><u>Panel doors</u></b>					
<b><u>Steel casement doors</u></b>					
A	900 x 2100 mm overall - single leaf	5	No.		
	Carried to collection				
	<u>Prepare surfaces and apply one coat (undercoat) and two coats polyurethane clear lacquer paint as "Crown Paints" or other equal approved: on steel surfaces: to</u>				

A	Door: general surfaces	20.0	Sm		
	<b><u>Ironmongery</u></b>				
	<u>Supply and fix English "Union" or other equal approved ironmongery: matching screws: locks to include a set of 3 keys: catalogue numbers refer to "Union catalogue issued by "Assa Abloy (E.A.) Limited" of Tel. No. +254-20-531569 and Fax No. +254-20-532077: schedule in the drawings section of the bill</u>				
B	2-lever Brass door handle	5	No.		
C	Rubber Door Stopper	5	No.		
	Carried to collection				
	<b><u>Collection</u></b>				
	From page 13				
	From page 14				
<b>TOTAL FOR DOORS CARRIED TO BUILDERS WORK SUMMARY</b>					
	<b><u>ELEMENT NO.6: WINDOWS</u></b>	-			
		-			
	<u>Approved pre-cast concrete cill: bedded and jointed in cement (sand (1:3) mortar: pointed in matching coloured cement</u>	-			
A	150 x 25 mm Thick cill; once weathered and throated	30	Lm		
	<u>Wrot cypress: prime grade</u>	-			
		-			
B	Pelmet box: 100 x 20 mm cypress top: 100 x 20mm fascia: 25 x 25 mm cypress bearer: 20 x 100 mm return ends	30	Lm		
	<u>Medium duty aluminium curtain rail to architects approval</u>	-			
C	Approved channel curtain rail track: double tracks: fixed to pelmet boxes: with and including glides at 50 mm	30	Lm		

	centres: end stops, fixing screws, laps and hooks: fixed to timber bracket				
		-			
	<u>Wrot hardwood</u>	-			
		-			
D	50 x 25mm battren	30	Lm		
		-			
E	12mm beading	30	Lm		
		-			
	<u>Prepare surfaces: and apply undercoat and two finishing coats first grade gloss enamel paint as "Crown Paints" or other equal approved: on wooden surfaces: to</u>	-			
F	Surfaces over 200 but not exceeding 300 mm girth: pelmet boxes	30	Lm		
		-			
	<i>Carried to collection</i>				
	<b><u>Windows</u></b>	-			
		-			
	<u>Supply, assemble and fix the following purpose made steel casement windows as " BOOTH" standards incorporating complete with fixing lugs on, hooded mosquito proofed permanent vent, pin type hinges including all necessary cutting, 4mm thick clear sheet glass(m.s) and glazing ironmongery (m.s) from "General steel fabricators". or other equal and approved manufacturers.</u>	-			
		-			
A	Window size 1500 x 1200mm high	20	NO		
		-			
		-			
	<u>4mm Thick clear sheet glass and glazing to steel casement windows with and including linseed putty: in panes</u>	-			
		-			
B	Panes: not exceeding 0.50 sm	30	Sm		
		-			
	<u>4 mm Thick obscured sheet glass and glazing to steel casement windows with and including linseed putty: in panes</u>	-			
		-			
C	Panes: not exceeding 0.50 sm	30	Sm		
		-			
	<i>Carried to collection</i>				
	<b><u>Collection</u></b>	-			
		-			

	From page 16				
	From page 17				
	From page 18				
<b>TOTAL FOR WINDOWS CARRIED TO BUILDERS WORK SUMMARY</b>					
<b><u>ELEMENT NO. 7: FINISHES</u></b>					
		-			
	<b><u>Floor finishes</u></b>	-			
	<u>Cement and sand (1:4) screed: to hacked floors: in</u>	-			
A	32 mm thick steel trowelled screed	200	Sm		
	<b><u>Internal wall Finishes</u></b>	-			
		-			
	<u>Plaster: 9 mm first coat of cement/lime putty/sand (1:2:9): 3 mm second coat of cement/lime putty/sand (1:1:6): steel trowelled: on masonry or concrete: to</u>	-			
C	Walls: internally	260	Sm		
	<u>Prepare surfaces and apply undercoat and two finishing coats silk vinyl emulsion paint as " Crown Paints" or other equal approved on plastered masonry or concrete surfaces: to</u>	-			
		-			
D	Walls: internally	300	Sm		
	Carried to Collection				
	<b><u>External wall finishes</u></b>				
	<u>Cement and sand (1:4) render: on concrete or masonry: steel trowel finished: to</u>	-			
A	15mm thick: to walls and concrete: externally to receive paint	200	Sm		

	<u>Prepare surfaces and apply undercoat and two finishing coats first grade emulsion paint as " Crown Paints" or other equal approved on plastered masonry or concrete surfaces: to</u>	-			
B	Walls and concrete: externally	200	Sm		
	<u>Key pointing</u>	-			
C	Key pointing to masonry walls : externally.	200	Sm		
	<b><u>Ceiling Finishes</u></b>	-			
	<u>Extra over softboard ceiling including 50x50 &amp; 75 x 50mm intermediate brandering @ 600mm centres to ceiling</u>	-			
D	Soffits	200	Sm		
	<u>Cornice</u>	-			
E	50 x 50mm cornice: one rounded junction with wall finish: one coved junction with ceiling finish: counter sinking and flush pelling	100	Lm		
	Carried to Collection				
	<u>Prepare surfaces and apply undercoat and two finishing coats silk vinyl emulsion paint as " Crown Paints" or other equal approved on gypsum ceiling surfaces: to</u>	-			
A	Soffits	100	Sm		
B	Surfaces over 100 mm but not exceeding 200 mm girth: Cornice	100	Lm		
	Carried to Collection below				
	<b><u>Collection</u></b>	-			
	From page 20				
	From page 21				
	From page 22				
	<b>TOTAL FOR FINISHES CARRIED TO BUILDERS WORK SUMMARY</b>				

	<b><u>ELEMENT NO.8: PRIME COST &amp; PROVISIONAL SUMS</u></b>				
	<i><u>ELECTRICAL WORKS</u></i>				
	-				
A	Provide a prime cost sum for electrical works of two hundred and fifty thousands kenya shillings	SUM	1		
B	Add for Profit	%	20		
	<b>TOTAL FOR PRIME COST &amp; PROVISIONAL SUMS CARRIED TO BUILDERS WORK SUMMARY</b>				-
	<b>SUMMARY</b>				
1	SUBSTRUCTURES				
2	WALLING				
3	SUPERSTRUCTURE CONCRETE				
4	ROOFING				
5	DOORS				
6	WINDOWS				
7	FINISHES				
8	PRIME COST & PROVISIONAL SUMS				
	SUB TOTAL				
	add 16%VAT				
	<b>TOTAL COST FOR 5NO. CLASSROOMS</b>				

**4No. TWO(2) DOOR VIP PIT LATRINE AT ADELE PRIMARY SCHOOL TANA RIVER COUNTY(EIGHT 8 DOORS IN TOTAL)**

Item No.	Description	Qty	Unit	Rate	Total
	<b>SUBSTRUCTURE (Provisional)</b>				
	<b>Excavation</b>				
	<u>Excavation including maintaining and supporting sides and keeping free from water, mud and fallen materials by bailing, pumping or otherwise</u>				
A	Prepare site by stripping top 200 mm of soil to remove all debris including sand (if any) from site and carting away spoil	M2	120.0		



B	Excavate for foundation strip commencing at stripped levels depth not exceeding 1.50m deep	M3	216.0		
C	Pit excavation commencing at stripped levels depth not exceeding 1.50m deep	M3	108.0		
D	Ditto 1.50 - 3.00 metres deep	M3	40.0		
E	Ditto 3.00 - 4.50 metres deep	M3	40.0		
F	Ditto 4.50 - 6.00 metres deep	M3	40.0		
G	Extra-over for excavation in rock	M3	10.0		
H	Remove surplus excavated material from site	M3	160.0		
I	Backfill around foundation	M3	180.0		
	<b>Filing</b>				
J	300 mm thick approved hardcore filling spread, well rammed and compacted in 150mm layers to receive concrete surface bed	M3	66.0		
	<b>Insitu concrete: class 15: mix 1:3:6</b>				
K	50mm blinding layer under foundations	M2	200.0		
L	50mm blinding layer on hardcore surfaces	M2	220.0		
	<b>Total from Substructures Collection 1</b>				
	<b>Concrete work</b>				
	<u>Reinforced Concrete class 15</u>				
A	Strip foundation	M3	24.3		
	<u>Reinforced Concrete class 25</u>				
B	100mm thick floor slab with surface steel trowelled smooth	M2	120.0		
C	Allow for pit/squat hole in 100mm thick floor slab	No	3.0		
	<b>Reinforcement</b>				
D	Reinforcement bars (asorted steel) as shown on drawings	Kg	648.0		
E	Mesh fabric reinforcement ref. No. A142 laid in floor slab with minimum 150 mm side allowance	m2	131.0		
	<b>Sawn formwork</b>				
F	Formwork to edges of floor slab girth over 75mm but not exceeding 150mm	M	99.0		
G	Formwork to edges of strip footing girth over 75mm but not exceeding 150mm	M	66.0		
H	Formwork to edges of strip footing girth over 150mm but not exceeding 2250mm	M	72.0		
	<b>Walling</b>				
I	400mm Thick coral stone retaining wall in cement and sand mortar (1:3)	M2	45.0		
J	300mm Thick coral stone foundation walling in cement and sand mortar (1:3)	M2	50.0		
K	150mm thick masonry wall	M2	6.0		
L	One layer 1000gauge polythene sheet damp proof membrane under beds: 300mm laps	M2	60.0		
M	200mm wide Bituminous felt damp-proof course	M	60.0		
	<b>Total from Substructures Collection 2</b>				

	<b>Steps</b>				
	<b>Concrete work</b>				
	<u>Reinforced Concrete class 25</u>				
A	Treads, 300 mm wide	M	15.0		
B	Risers, 150 mm high	M	12.0		
C	Open string	M2	0.9		
D	Waist	M2	0.6		
	<b>Sawn formwork</b>				
E	Risers: girth over 75mm but not exceeding 150mm	M	10.0		
F	Open string	M2	0.8		
G	Waist	M2	0.6		
	<u>Cement and sand mortar (1:4) trowelled beds: on concrete: to</u>				
H	Treads, 300 mm wide	M	12.0		
I	Risers, 150 mm high	M	10.0		
J	Open string	M2	0.8		
K	Waist	M2	0.6		
	<b>Reinforcement</b>				
P	High tensile reinforcement bars in assorted sizes	KG	210.0		
	<b>Total page 3 to Substructures Collection</b>				
	<b>Plinths</b>				
A	15mm thick cement sand rendering (1:3) to plinths	M2	18.0		
B	Prepare and apply three coats black bituminous paint to rendered plinths externally	M2	18.0		
	<b>Total from Substructures Collection 3</b>				
	<b><u>SUBSTRUCTURES COLLECTION</u></b>				
	<b>Total from Collection 1</b>				
	<b>Total from Collection 2</b>				
	<b>Total from Collection 3</b>				
	<b>SUBSTRUCTURES SUB TOTAL TO SUMMARY</b>				
	<b>SUPERSTRUCTURES</b>				
	<b>Walling</b>				
A	150mm Thick load bearing solid concrete block walling	M2	144.0		
	200mm deep x 400mm wide vent block	No	6.0		
	<b><u>Wall Coping</u></b>				
B	Precast concrete 600 x 300 x 50 mm Thick twice weathered and throated coping jointed and pointed in cement and sand mortar	M	21.0		
	<b>Concrete Work</b>				
	<u>Vibrated reinforced concrete class 25 (1:1.5:3) with 20mm maximum aggregate as described in:</u>				
C	Lintels	M3	0.4		

	<b>Reinforcement</b>				
D	8mm Diameter high tensile reinforcement bar	Kg	24.0		
E	Ditto but 10mm	Kg	33.0		
	<b>Sawn Formwork to:</b>				
F	Sides and soffits of lintels	M <sup>2</sup>	3.3		
	<b>Roofing</b>				
	<b><u>Roof Structure</u></b>				
	<u>Sawn celcured cypress timber as described in:</u>				
G	200mm x 15mm Fascia Board	M	39.0		
H	100x50mm Rafters	M	33.0		
I	100mm x 50mm wall plate	M	36.0		
J	50 x 50 Purlins	M	60.0		
	<b><u>Roof Covering</u></b>				
K	0.5mm color coated Fiberglass corrugated roofing sheets screwed to purlins - Blue in color	M <sup>2</sup>	36.0		
	<b>Total from Superstructures Collection 4</b>				
	<b>Painting and Decorating</b>				
L	Knot prime stop and apply two undercoats and one gloss finishing coat oil paint to fascia board 200- 300 mm wide	M	39.0		
	<b>Doors</b>		0.0		
A	45mm thick Match boarded timber single door, overall size 900x 2100mm high	No	4.5		
	<b><u>Wrot cypress 1st grade</u></b>				
B	150x50mm frame two labours plugged screwed and pelltated	M	60.0		
C	50x25mm architrave two labours	M	60.0		
D	25x15mm quadrant one labour	M	60.0		
	<u>Supply and fix the following ironmongery to timber with matching screws</u>		0.0		
E	Stainless steel hinges	Pairs	8.0		
F	Tower bolt lock	No	20.0		
G	Rubber door stop	No	6.0		
H	Prepare and apply two undercoats and one finishing coat oil paint to timber door - Blue in Color	M <sup>2</sup>	24.0		
	<b>Total from Superstructures Collection 5</b>				
	<b>Finishes</b>				
	<b><u>Floor Finishes</u></b>				
	<u>Cement and sand mortar (1:4)trowelled beds: on concrete: to</u>				
A	32mm floors Trowelled finished	M <sup>2</sup>	70.0		
B	100mm diameter Heavy duty uPVC soil and vent pipe 3000mm high fastened to wall with plastic clips at 400c/c with wire grating tied to top of pipe	No	6		
	<b><u>Wall Finishes</u></b>		0.0		
	<u>15mm cement and sand (1:4) backing; steel trowelled finish</u>		0.0		

D	Walls internally	M2	244.0		
	<u>12mm lime plaster: steel trowelled finish: on concrete, block work or stonework: to</u>				
F	Walls externally	M2	120.0		
	<u>Prepare and apply three coats plastic emulsion paint to:</u>				
G	Walls externally	M2	120.0		
H	Extra over keying	M2	36.0		
J	Provide branding and paintwork with Islamic Relief Logo and Project details	ITEM	4		
	<b>Total from Superstructures Collection 6</b>				
	<b><u>SUPERSTRUCTURE COLLECTION</u></b>				
	<b>Total from page 4</b>				
	<b>Total from page 5</b>				
	<b>Total from page 6</b>				
	<b>SUPERSTRUCTURE SUB TOTAL TO SUMMARY</b>				
	<b>SUMMARY</b>				
	<b>(1) SUBSTRUCTURE</b>				
	<b>(2) SUPERSTUCTURE</b>				
	<b>Total</b>				
	<b>ADD VAT 16%</b>				
	<b>GRAND TOTAL</b>				

## **ANNEX II: DRAWINGS**



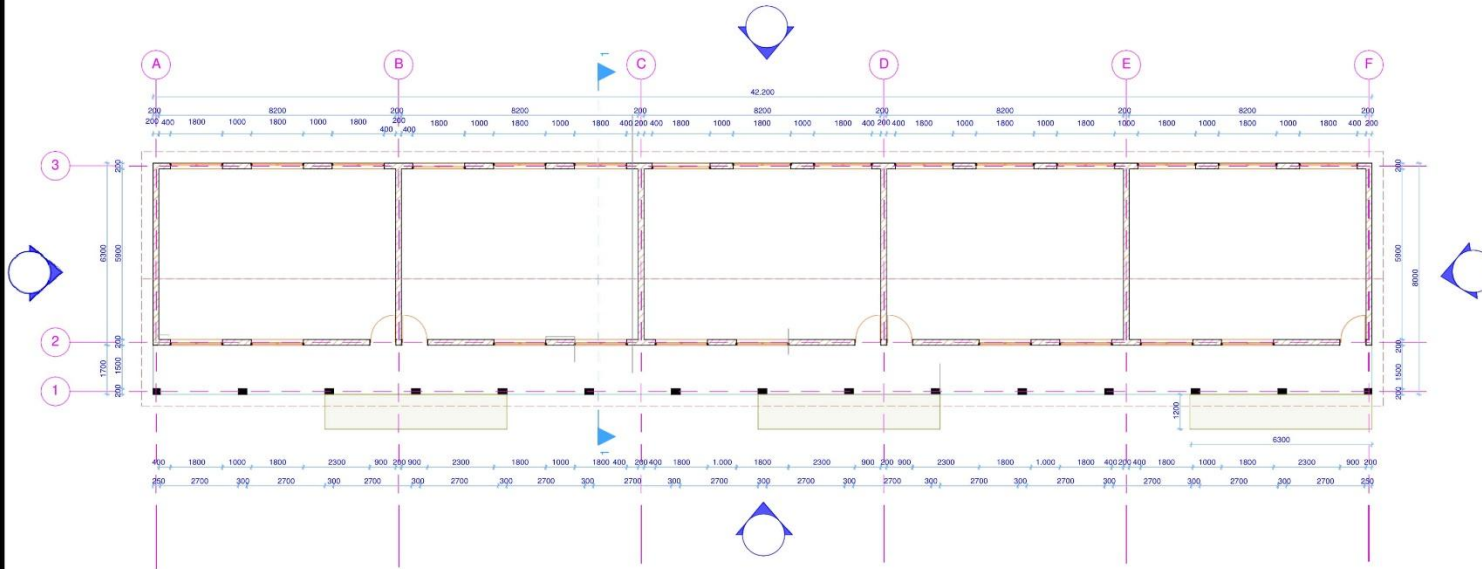

**FLOOR PLAN**

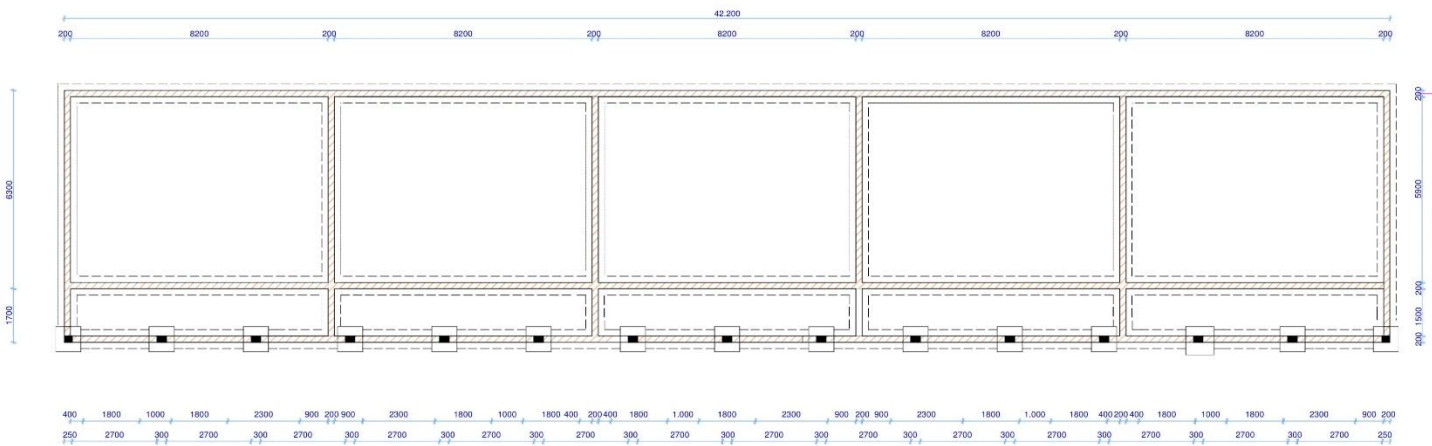

**FOUNDATIONS PLAN**

**NOTES**

- All dimensions in mm
- Foundation depth to be determined on site by Architect/ Engineer
- RC work shall conform to Engineer's details and instructions.
- Damp proof course shall be 3 ply bituminous felt or equally approved
- Permanent air vents to be provided to doors and windows.

**REVISIONS**

No.	Date	Revision/Issue

**DESIGNED BY**

EVANS

**DRAWN BY**

EVANS

July 2024

**CHECKED BY ANDREA**

**SIGN**

**CLIENT**

ISLAMIC RELIEF, KENYA

**PROJECT TITLE**

THE PROPOSED CONSTRUCTION OF 5No CLASSROOMS AT ADELE PRI SCHOOL

**DRAWING**

FLOOR AND FOUNDATIONS PLAN

**SCALE**

1:100

**DRG No.**

SNE/M/002





**FRONT VIEW**

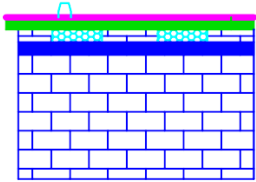

**SIDE VIEW**

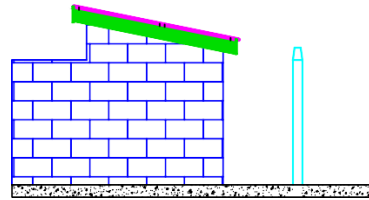

**SECTIONAL VIEW**

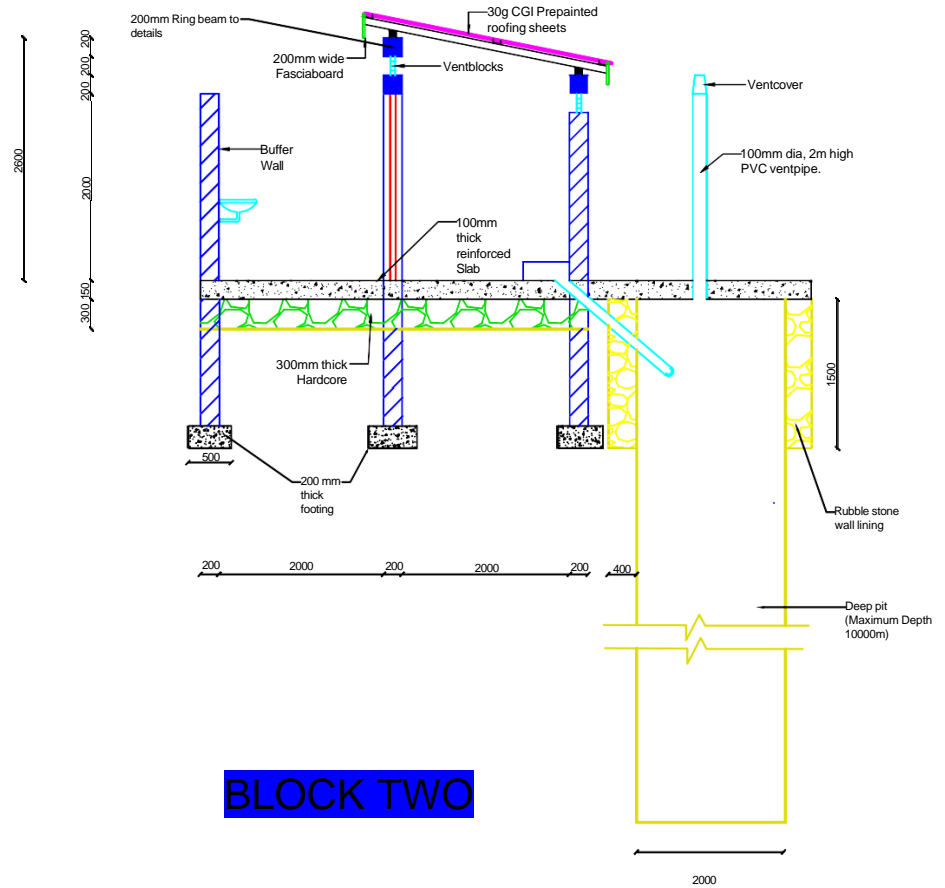

**BLOCK TWO**

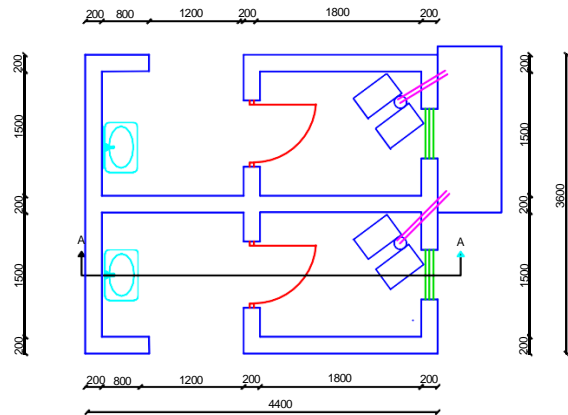

CLIENT:  
ISLAMIC RELIEF, KENYA

PROJECT:  
CONSTRUCTION OF VIP LATRINE BLOCK AT BANGAL

SCHOOL

DRAWING:  
FLOOR PLAN,

ELEVATIONS AND SECTIONS

**FRONT VIEW**

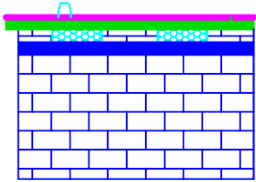

**SIDE VIEW**

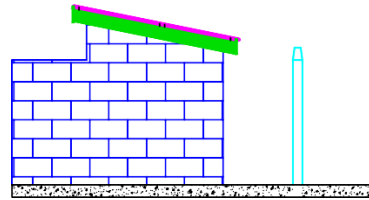

**SECTIONAL VIEW**

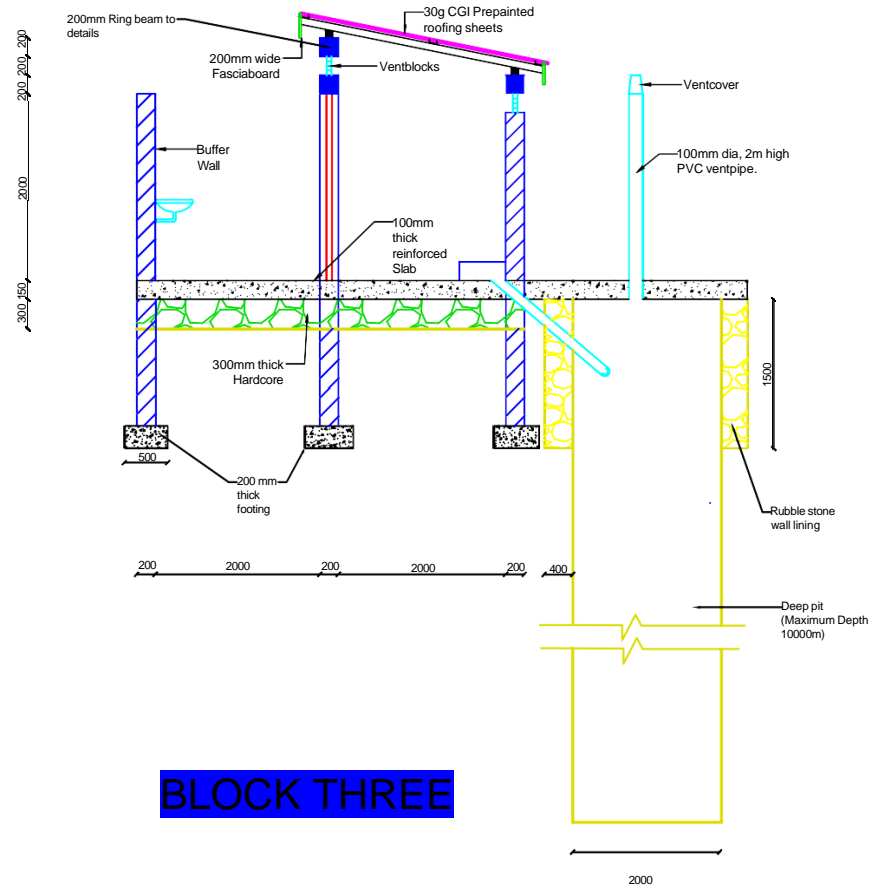

**BLOCK THREE**

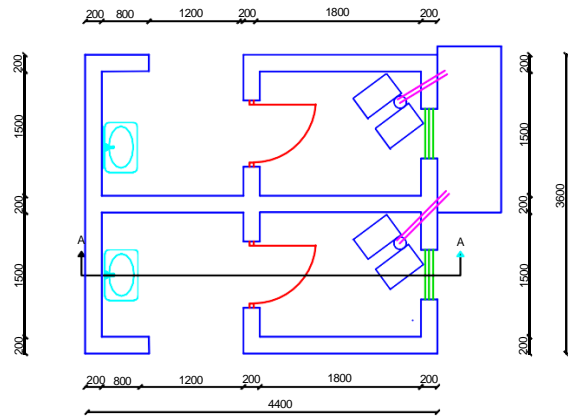

CLIENT:  
ISLAMIC RELIEF, KENYA

PROJECT:  
CONSTRUCTION OF VIP LATRINE BLOCK AT BANGAL

SCHOOL

DRAWING:  
FLOOR PLAN,

ELEVATIONS AND SECTIONS

**FRONT VIEW**

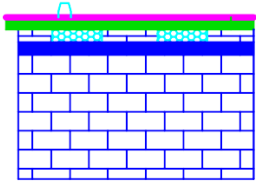

**SIDE VIEW**

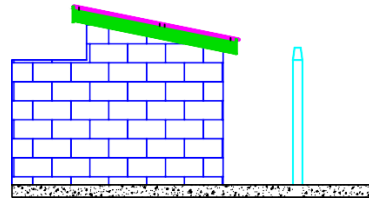

**SECTIONAL VIEW**

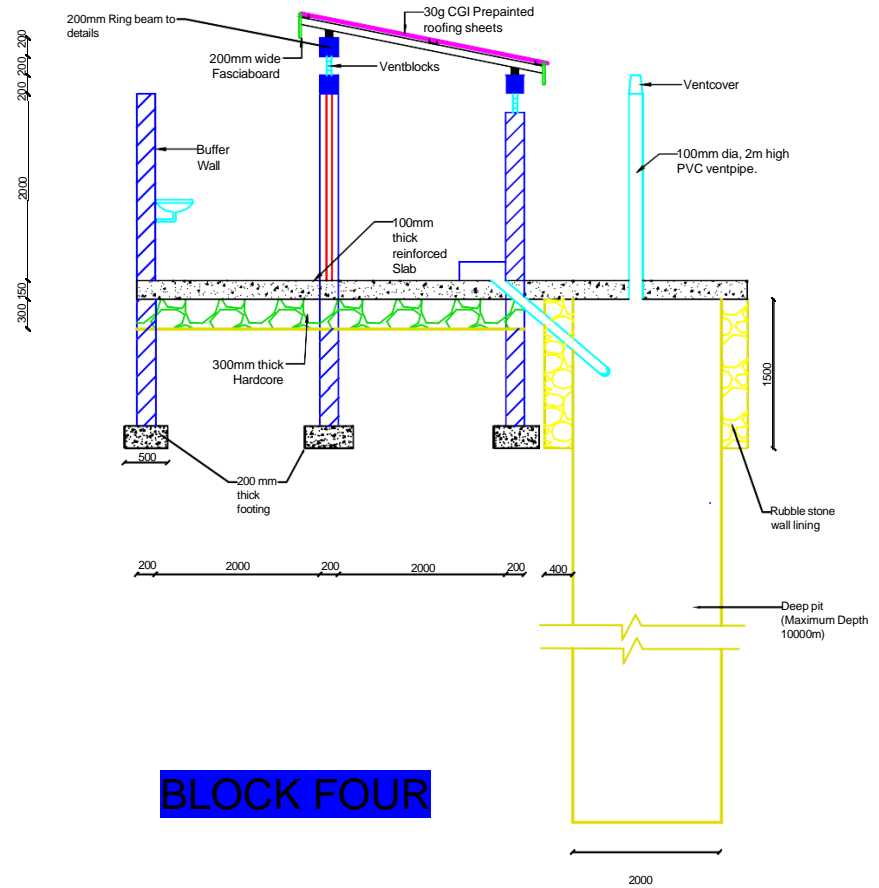

**BLOCK FOUR**

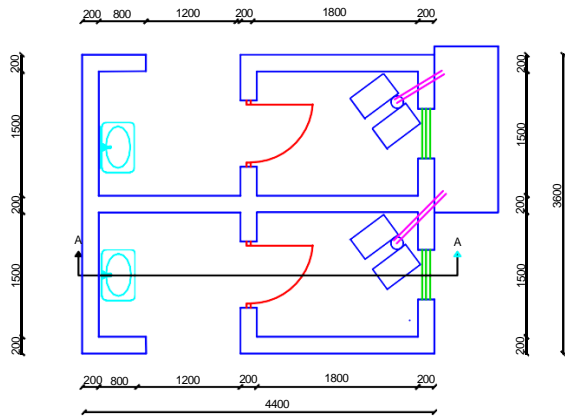

CLIENT:  
ISLAMIC RELIEF, KENYA

PROJECT:  
CONSTRUCTION OF VIP LATRINE BLOCK AT BANGAL

SCHOOL

DRAWING:  
FLOOR PLAN,

ELEVATIONS AND SECTIONS