



Islamic Relief Kenya

TENDER DOCUMENT FOR

REHABILITATION WORKS AT BUKUMA BOREHOLE IN WAJIR WEST SUB-COUNTY, WAJIR COUNTY

REF NO: IRK/WAJ/BR/WORKS/004/11/2024

ISSUED ON: SATURDAY, NOVEMBER 9, 2024

CLOSING DATE: MONDAY, NOVEMBER 25, 2024, 11.00 AM

NAME AND CONTACT OF PROCURING ENTITY:

Islamic Relief Kenya
Kirichwa Road, off Ngong Road
P.O.BOX 417 – 00202 KNH, Nairobi
Email: procurement.Irk@islamic-relief.or.ke

INSTRUCTION TO BIDDERS

Established in 1984 in the UK, Islamic Relief is an international NGO seeking to promote sustainable economic and social development by working with local communities through relief and development activities regardless of race, color and religion, and without expecting anything in return.

IR started operations in Kenya in 1993 on orphan's sponsorship programme through a local CBO in Mandera District, Northern Kenya. It opened its fully fledged office in March in 2006 at the height of drought in the Horn of Africa. Since then, IR has been providing humanitarian and development assistance to vulnerable communities. Over these years it has implemented various development and relief activities in Mandera. This has remarkably changed the lives of the vulnerable and disadvantaged communities. In January 2010, IRK extended its operation to Wajir County and in January 2012 expanded to Garissa and Dadaab, and in October 2017 opened a programme office in Kilifi County.

Islamic Relief Kenya focuses on resilience projects namely: Food Security and Livelihoods, Water Sanitation and Hygiene, Cash Transfer Programming, Orphans Support and Sponsorship, women Empowerment, Education and Peacebuilding.

The Bracc project is under implementation in Wajir County Kenya. It aims to implement inclusive climate adaptation and resilience actions and strategies at grass root levels to increase the adaptive capacity and level of climate resilience of the target communities, the project outcomes are,

1. Increased access to potable and sufficient water for human and livestock consumption and for small-scale irrigation.
2. Improved agricultural and livestock productivity through supporting extension services and climate smart agricultural practices, for optimal food production.
3. Increased income and asset growth for unemployed urban, and peri urban youths.
4. Strengthened community managed disaster risk reduction capacity.

To achieve this, IRK is raising this tender document for rehabilitation, piping and construction works at Bukuma borehole in Wajir west sub-County, Wajir county to enable increased access to water for the targeted local communities.

A complete set of tender documents may be obtained Free of Charge by interested candidates by downloading from the link provided: Islamic Relief Kenya website: <https://islamic-relief.or.ke>

Bid Submission Requirements.

Interested bidders are advised to read the submission instructions carefully to ensure compliance.

Submission Email: To be submitted via email: tenders@islamic-relief.or.ke

Single PDF Document: Each bid must be submitted as a single, consolidated PDF document (**Max 25mb**). Multiple or fragmented submissions will not be accepted.

Direct PDF Attachment Only: Bid documents must be attached directly as PDF files in the submission email. Links to external file-sharing platforms, such as Google Drive or Dropbox, are not permitted and will not be reviewed.

Subject Line Specification: Bidders must include the **tender name** and **reference number** in the email subject line to ensure proper filtering and identification of submissions.

Disqualification Notice: Failure to adhere to these submission requirements will result in the disqualification of the bid.

Tender Name: Rehabilitation, Piping and Construction Works Bukuma Borehole in Wajir West Sub-County, Wajir County

Tender Ref No: IRK/WAJ/BRWORKS/004/11/2024

Submission Deadline: Monday, 25th November 2024 at 11:00 am

Tenders will be opened immediately thereafter in the presence of bidders or their representatives who choose to attend in the Islamic Relief Boardroom. Any tender documents received later than the deadline will not be accepted.

At the tender opening, IRK will announce the tender's names, total tender price, and such other details as the Employer, at his discretion, may consider appropriate. No tender shall be rejected at the tender opening except for late tenders. Tenders not opened and read out at the tender opening shall not be considered further for evaluation, irrespective of the circumstances.

Prices quoted should be inclusive of all taxes, must be in Kenya shillings and shall remain valid for (60) days from the closing date of tender.

INSTRUCTION TO BIDDERS

PROCURING ENTITY: ISLAMIC RELIEF KENYA. P.O BOX 417-00202 KNH, Nairobi

REHABILITATION, PIPING AND CONSTRUCTION WORKS AT BUKUMA BOREHOLE IN WAJIR WEST SUB-COUNTY, WAJIR COUNTY.

1. All Tenders above must be accompanied by a Bid Bond at least 10% of the quoted amount valid for 180 days.
2. **Only** tenders submitted electronically will be accepted. Late tenders will be rejected

3. Work Scope and Sites Details

The tender is for undertaking the following components as per Annex I – BoQ and Annex II – Drawings: rehabilitation, piping and construction works at Bukuma borehole in Wajir west sub-county, Wajir county.

Eligible Bidders

The invitation for the bids is open to all interested eligible Companies/individuals who are duly registered with the national government, respective County governments and National construction authorities.

4. Services

All services to be done under the contract shall have their measurement and shall not be subcontracted.

5. Cost of Bidding

The bidders shall bear all costs associated with preparation and the submission of its bid & IRK will in no case be responsible for those costs, regardless of the conduct or outcome of the bidding process.

6. Clarification of Bidding Documents

Interested eligible candidates who may want to obtain further information or seek for clarification can do so by sending an email to Procurement.Irk@islamic-relief.or.ke OR +254 727531220 / 2543861216. IRK will respond in writing to any request prior to the deadline.

If you have any concerns – relating to this tender or otherwise – or want to make a complaint please: Call us on +254 700 200 849 or Email us at: complaints@irworldwide.org

7. Amendment of Bidding documents

At any time prior to the deadline for submission of bids, IRK May for any reason, at its own initiative or in response to a clarification requested by a prospective bidder, modify the bidding documents & will be binding on them. The amendment will be notified in writing to all prospective bidders, who have received the bidding documents & will be binding on them. In order to allow prospective bidders responsive time in which to take the amendment into account in preparing their bids, IRK may, at its discretion, extend the deadline for bid submission.

8. Language of the Bid

The bid prepared by the bidder, as well as all correspondence & documents relating to the bid, supporting documents and printed literature furnished by the bidder shall be written in English language.

9. Bid Document Comprises.

The bid document prepared by the bidder shall comprise of the following:

- a) Each page of the tender document is serialized.
- b) Form of tender signed and stamped by the authorized person.
- c) Tender submitted with tender security as required (bid bond 10% of the quoted amount)
- d) Completed and signed confidential business questionnaire form.
- e) Certified Copy of Certificate of Incorporation/Registration.
- f) Disclosure of business ownership (Directors/ Partners /Sole Proprietor). Attach a copy of CR12 Form
- g) Certified Copy of Current Tax Compliance certificate from Kenya Revenue Authority – must verifiable online –itax
- h) KRA PIN with VAT obligation
- i) Certified Copy of Valid and current Business Permit
- j) Certified copy of Valid registration for National Construction Authority NCA 7 and above - Building and water works
- k) Bidder to provide self-declaration that the person/tenderer will not engage in any corrupt or fraudulent practice.
- l) Only certified Statement of comprehensive income for the last three years (**Max. 3 pages**) signed by auditors.
- m) Company Profile with brief business description, **physical location**, address and company structure (Max. 5 pages).
- n) Evidence of Past Experience in Similar work done for the last 5 years e.g. at least 5 signed contracts supported by LPO and Certificate of Completion
- o) Copy of ID/Passport for Company Owner/Director
- p) Bid bond (10% of the quoted amounts)
- q) Key Technical staff and their CVs (**Key people but not more than four CVs**)
- r) List of Key Equipment (**only relevant equipment**).
- s) Detailed workplan and methodology statement: Work plan demonstrating flow of work from inception to site hand over) (**Max 3 pages**)
- t) Bank Statement for 6 months (**1st May 2024 – 30th October 2024**)
- u) Duly filled Tender B.o.Q and forms in the format provided
- v) All copies of certified/mandatory documents must be Certified by a Commissioner of Notary/ Oath.

10. Bid Currencies

The bids prices shall be quoted in Kenya Shillings (KES).

11. Bids Prices

- The potential contractor shall submit his/her bid in the BOQ format provided in Annex I
- The bidders shall indicate the unit price where possible and the total bid price as indicated in the BOQ.
- Prices quoted by the bidder shall be fixed during the performance of the contract.

12. Withholding Tax

IRK shall retain 3% of contract value as withholding tax and remit to the government. A receipt shall be issued for this.

13. Retainer

IRK shall retain 10% of the contract value for a period of 6 months being defect liability.

14. IRK's right to vary quantities at the time of the award

IRK reserve the right at the time of the award of contract to increase or decrease by up to 10% the quantity of work specified in the technical specification without change of unit price or other terms of condition.

15. IRK's right to accept any bid and/or reject any or all bids

IRK reserves the right to accept any bid and to annul the bidding processes and reject all bids at any time prior to award of contract, without, thereby incurring any liability to the affected bidder or bidders or any obligation to inform the affected bidder or bidders on the grounds of its action.

16. Submission of Bids

The bidders shall submit their bids in one envelope marked with Tender Name and Reference.

17. Evaluation

18.1 IRK will examine the prequalification documents to determine completeness, general orderliness, sufficiency in responsiveness, price and product brand.

18.2 The potential contractor shall not contact IRK on matters relating to their bid from the time of opening to completion and official communication sent to them. Any effort by the potential contractor to influence IRK in the evaluation shall result in disqualification.

18.3 Prequalification will be based on meeting the minimum criteria regarding the applicant's legal status, general and experience, personnel and financial position as demonstrated by their responses as set in clause

18.4 The applicants **MUST** have registered offices and IRK reserves the discretion of visiting physical premises from which the applicant conducts business if so desired to confirm existence and capability to execute the contract.

18.5 Due diligence shall be undertaken, and any bidder found to be in breach by providing false information shall be disqualified.

19. Employment of Minors

The Contractor shall not employ children in executing the contract. The Contractor shall observe international conventions relating to child labor namely the UN Convention No.182 on worst forms of child labor and convention No. 138 on the minimum age for admission to employment.

20. Criminal Act

The Contractor undertakes to comply with all applicable laws and to ensure that it does not engage in any kind of criminal activity including but not limited to bribery, fraud, corruption, terrorism and to maintain ethical business practices as well as not to commit any Prohibited Acts defined as: -

- i) To offer, promise or give any person a financial or other advantage.
- ii) To request, agree to receive or accept any financial or other advantage not expressly provided for as an inducement or a reward for the performance of any function or activity in connection with this Agreement.

BID EVALUATION RATING SCALE

MANDATORY REQUIREMENTS

No	Description	Mandatory Evaluation (YES/NO)
1	Company Registration Certificate – Mandatory	
2	CR12- issued within the last 3 months	
3	Duly filled forms (Organization details, Grounds for Mandatory Rejection, Grounds for Discretionary rejection form, Bid Value, Financial and declaration)	
4.	Valid Registration with the county government/valid and genuine business permit.	
5.	Valid Registration with (NCA7 and above). (Building and water work)	
7	Active KRA PIN – With VAT Obligation	
8	Valid Tax Compliance	
9	Copy of ID/ Passport of the directors	
10	Serialization of the Bid – Bidders shall sequentially serialize all pages of the	

Note: Bids that do not include any of the documents listed as mandatory will not be considered for either the technical or financial evaluation.

TECHNICAL EVALUATION

No.	Description	Score	
1	Brief Company Profile with verifiable physical location/address	10	
2	List of Key Equipment	Owned (Max 15 marks)	20
		50% Owned – 50% leased (Max - 7)	
		100% leased (Max. 5 Marks)	
3	List of Key Personnel	(Degrees- 10, HNDs – 6, Diplomas – 4)	20

4	Number of Years in Operation at least 5 years	1yr - 2 marks 2yrs- 4 marks 3yrs- 6 marks 4yrs- 8 marks 5yrs & above – 10 marks	10
5	Evidence of past similar works – Contract, LPO & Completion certificates.	-5 or More = (Max. 30 marks) 4 LPOs, contracts & completion cert. (Max 24 marks) 3 LPOs, contracts & completion cert. (Max 18 marks) 2 LPOs, contracts & completion cert. (Max 12) 1 LPO/contracts/completion cert (Max 4 Marks) Note: the contract/LPOs/completion certificate must be readable, signed and stamped by the issuing authority for authentication.	30
6	Detailed work plan and methodology statement	Detailed workplan and methodology statement: Work plan demonstrating flow of work from inception to site hand over) (Max 3 pages)	10
	TOTAL	100	

Note: Bids that do not score 80% or above in the technical analysis will be automatically disqualified and will not be considered for financial evaluation.

FINANCIAL EVALUATION

No.	Description		Maximum
1	Certified Bank statement for the past six months (1st May 2024 – 30 th October 2024).	Certified bank statement for 6 months. Uncertified bank statement -0	25
2	Evidence of a Certified letter of credit from the reputable from reputable bank.	Certified letter (signed & stamped) of credit.	25
	TOTAL		50

Note: Bids that do not score 75% or above in the financial analysis shall not be considered for due diligence.

Tender Schedule

Task	Tentative Tender Schedule
Advertising of tender	Saturday, November 9, 2024
Closing of tender	Monday, November 25, 2024, 11:00 am
Opening of tender	Monday, November 25, 2024, 11:00 am
Evaluation	26 th – 29 th October 2024
Award	2 nd -4 th November 2024

MANDATORY QUESTIONNAIRE

A: Organization and Contact Details

Full Name of Organization			
Date of Registration			
Registration Certificate Number			
Street		Road	
Address		Code	
Town			
Email		Telephone No.	
PIN No.			
Name of Parent Company			
Type of Organization	A Public Limited Company		
	A Limited Company		
	A Limited Liability Partnership		
	Other Partnership		
	Sole Trader		
	Other (Please Specify)		

Name of Owners

Name	ID/Passport No.	Nationality

DETAILS FOR CONTACT PERSON

Contact details for enquiries about this PQQ/Business Issues

Name of Staff	
Address	
Post Code	
Town	
Phone	
Mobile	
Email	

B - Grounds for Mandatory Rejection

Important Notice:

In some circumstances IRK is required by law to exclude you from participating further in a procurement. If you cannot answer 'no' to every question in this section it is very unlikely that your application will be accepted, and you should contact us for advice before completing this form.

Please state 'Yes' or 'No' to each question.

Has your organization or any directors or partner or any other person who has powers of representation, decision or control been convicted of <u>any of the following offences?</u>	Answer
(a) A crime	
(b) Corruption	
(c) The offence of bribery;	
(d) Fraud within the meaning of:	
i) Money laundering	
ii) Any other offence	

Has your organization fulfilled obligations related to the payment of social security contributions or the payment of taxes in accordance with the legal? Answer with a "Yes" or "No"	
---	--

C - Grounds for Discretionary Rejection

Important Notice:

IRK is entitled to exclude you from consideration if any of the following apply but may decide to allow you to proceed further. If you cannot answer 'no' to every question it is possible that your application might not be accepted. In the event that any of the following do apply, please set out (in a separate Annex) full details of the relevant incident and any remedial action taken subsequently. The information provided will be taken into account by IRK in considering whether or not you will be able to proceed any further in respect of this procurement exercise. Please state 'Yes' or 'No' to each question.

<u>Is any of the following true of your organization?</u>	
(a) <u>Is bankrupt</u> or under receivership or bankruptcy restrictions order made against the organization	
(b) <u>Is insolvent,</u>	
(c) <u>Is</u> the subject of an order by the court winding up otherwise than for the purpose of bona fide reconstruction or amalgamation, or had a receiver, manager or administrator on behalf of a creditor appointed in respect of the company's business or any part thereof or is the subject of similar procedures under the law of any other state?	
<u>Has your organization</u>	
(a) been convicted of a criminal offence relating to the conduct of your business or profession;	
(b) committed an act of grave misconduct in the course of your business or profession;	
(c) failed to fulfil obligations relating to the payment of social security contributions	
(d) failed to fulfil obligations relating to the payment of taxes under the	

(e) been guilty of serious misrepresentation in providing any information required	
--	--

D – Bid Value & Duration of Supply

<i>Bid Value for the Work</i>	<i>Kshs.</i> _____
<i>Payment Terms</i>	
<i>Duration of Delivery</i>	
<i>Remarks</i>	

E - Financial

1	BANK INFORMATION	
1.1	<i>Bank</i>	
	<i>Branch</i>	
	<i>Account Name</i>	
	<i>Account Number</i>	
	<i>Swift Code</i>	
	<i>Letter From Bank Confirming Account & Credit Facility</i>	

F Declaration Declaration

2.	<p>I declare that to the best of my knowledge the answers submitted in this bid document are correct. I understand that the information will be used in the process to assess my organization's suitability to be invited to tender for Islamic Relief's requirement and I am signing on behalf of my organization. I understand that the Contracting Authority may reject this bid if there is a failure to answer all relevant questions fully or if I provide false/misleading information. By signing the bid document, I certify that all of the above statements are accurate and factual.</p> <p style="text-align: center;">FORM COMPLETED BY</p>	
2.1	Name:	
2.2	Position:	
2.3	Signature:	
2.4	Date:	

2.5	Stamp:	
-----	--------	--

Name of Bidder: _____

Authorized signature: _____

Name of Authorized signatory: _____

Functional Title: _____

Telephone Number: _____

Email Address: _____

Date: __/__/2024

Official Stamp:

ANNEX I: B.O.Q

Islamic Relief Kenya Kirichwa Road P.O Box 417-00200, KNH Nairobi, Kenya 3		Tel: 0727531220/0734740074 Email: info@islamic-relief.or.ke Ref: Date.....
---	---	---

BILLS OF QUANTITIES FOR WORKS OF REHABILITATION, PIPING AND CONSTRUCTION WORKS AT BUKUMA BOREHOLE

ITEM	DESCRIPTION	UNIT	QTY	RATE	AMOUNT
1	BILL No.1 CLEAR COMPOUND AND PAINTING OF POWER CONTROL HOUSE				
1.1	Clearing compound				
A	Clear compound of all shrubs and grass within compound	SM	4,900		
1.2	Painting and decoration				
A	Plastic emulsion paint on all masonry and concrete	SM	104		
B	Provide gloss paint to all plastered surfaces	SM	104		
	TOTAL FOR CLEARING COMPOUND AND PAINTING OF CONTROL HOUSE				
2	BILL No.2 REPAIR OF EXISTING ELEVATED TANK				
2.1	Repair of existing 9m high 50m ³ (5m*5m*2m) elevated steel tank				
A	Allow for the repair of existing elevated steel tank for any leakage points, fasten and replace panels where applicable by way of bolting and any other possible defects to reinstate tank tank to full functionality.	ITEM	1		
B	Allow for repair of access steel ladder and railings on structure and provide adequate anchorage.	ITEM	1		
C	Provide one coat of grey primer and two coats of silver aluminium externally on all external components	ITEM	1		
D	Excavate 1m*1m*0.35m for tap stand plinth next to elevated tank.	CM	0.35		
E	Provide, place and compact hardcore 200mm deep and apply murrum blinding.	CM	0.20		
F	Construct brc142 reinforced concrete grade 20/25 plinth 1m by 1m by 150mm thick by the tap stand close to elevated steel tank and direct water away from elevated tank base.	CM	0.15		
	TOTAL FOR REPAIR OF EXISTING ELEVATED TANK CARRIED TO GRAND SUMMARY				
3	BILL No.3 RENOVATION OF 1No. LATRINE WITH BATHROOM				
3.1	Roof Covering				
	Galvanized corrugated sheet roofing; 30 gauge; pre-painted				

A	Roof covering not exceeding 450mm from horizontal fixing to timber structure (m/s) with roofing nails and neoprene washer, j bolts, nuts and caps	SM	2		
3.2	Carpentry				
	The following in sawn celcured cypress all provisional				
A	200 x 25mm thick fascia board	LM	6		
	TOTAL FOR ROOF REPAIR CARRIED TO SUMMARY				
3.3	DOORS REPAIR				
A	Iron tower bolts fixed on inside and outside faces of doors	No.	2		
B	Prepare and apply three coats oil paint mahogany/varnish or other equal and approved to general surface of door frames	SM	3		
C	3No. hinges for the 2No doors each	No.	6		
D	Inject cement mortar to all door frame holes and hacked areas with cracks and fix with chicken wire and mortar (1:3)	CM	2		
	TOTAL FOR DOORS REPAIR CARRIED TO SUMMARY				
3.4	Wall and Floor repairs				
A	Hack wall finishes including deep cracks, remove all debris inside and outer part of the structure and dispose off properly	SM	23		
B	Inject cement mortar to all holes and hacked areas with cracks and fix with chicken wire and mortar (1:3)	SM	23		
C	Hack and demolish existing floor finishes including deep cracks and cart away debris.	SM	7		
D	38mm thick one coat backings; steel trowelled smooth to concrete base finished to floors level.	SM	7		
E	Wash and disinfect walls and floors	SM	30		
	Total for wall and floor repairs				
3.5	Paint and decoration				
A	Plastic emulsion paint on all masonry and concrete	SM	27		
B	Provide gloss paint to all plastered surfaces	SM	27		
C	Provide gloss paint to fascia board	LM	6		
D	Provide deep gloss paint to the metal sheet covering the doors.	SM	3		
	Total for paint and decoration				
3.6	Hand washing station				
A	Portable Handwashing station to be firmly anchored to the ground	Sets	1		
B	Hose pipe for connecting to tap and inter hose connector	Sets	2		
	TOTAL FOR HANDWASHING STATION CARRIED TO SUMMARY				
	TOTAL FOR 1No. LATRINE AND BATHROOM REHABILITATION				
4	BILL No.4: CONSTRUCTION OF 50M³ MASONRY TANK				
4.1	Element No.1: Excavation & Earth Works				
A	General excavation to remove top soil to an average depth of 250mm	CM	7.00		
B	General Excavation for foundation depth not exceeding 500mm	CM	14.00		
C	Cart away surplus excavated material & deposit at recommended area	CM	21.00		

D	300mm thick approved hard-core, well compacted in layers not exceeding 150mm and blinded using 50mm murrum/quarry dust	CM	12.00		
	Carried to Collection				
4.2	Element No.2: Masonry Work				
A	150 x225X 250mm natural stone to walling in 1:3 sand/cement mortar finished with steel finished on one side.	m	380.00		
	Carried to Collection				
4.3	Element No.3: Concrete Work				
A	Reinforced concrete grade 25/20 - 150mm thick floor slab	CM	4.00		
B	Reinforced concrete grade 25/20 - in 800 X 800mm X200mm THK sump	CM	0.15		
C	Reinforced concrete grade 25/20 - 150mm thick floor slab	CM	4.00		
D	Reinforced concrete grade 15 in support to access ladder	CM	0.15		
	Carried to Collection				
4.4	Element No. 4: Concrete Ancillaries				
4.4.1	Formwork				
	Provide cut and fix in position sawn timber formwork or equivalent.				
A	Edges ground slab 150mm wide	M	20.00		
B	Sump edges, 200mm Deep	M	2.00		
C	Edges of roof slab 200mm THK	M	20.00		
D	Underneath roof slab, including props	SM	20.00		
4.4.2	Reinforcement				
	Steel reinforcement cut, bend & placed in position, unit price to include cutting, bending & placing in position with binding wire and concrete seats				
A	10mm diameter high tensile steel (0.62kg/m ²) in floor slab	M	230.62		
B	12mm diameter high tensile steel (0.62kg/m ²) in floor slab	M	214.54		
C	10mm diameter high tensile steel (0.62kg/m ²) in offtake sump	M	35.00		
D	16mm diameter high tensile steel (1.58kg/m ²) in roof slab	M	8.00		
E	10mm diameter high tensile steel (0.22kg/m ²) in roof slab	M	458.56		
F	8mm diameter mild steel (0.39kg/m) in masonry walling	M	720.00		
	Carried to Collection				
4.5	Element No.5: Pipes and Fittings				
	All pipes to be Galvanised Iron with Screw				
A	100mm Diameter, 90 ⁰ GI bend	No.	4.00		
B	100mm Diameter barrel nipple	No.	1.00		
C	150 X 100mm GI reducing Socket	No.	1.00		
D	100mm GI Socket	No.	8.00		
E	100mm Diameter Flange	No.	4.00		
F	100mm Gate Valve	No.	3.00		
G	50mm Float valve complete with 100/50mm Reducer fittings	No.	1.00		
	Carried to Collection				
4.6	Element No.6: Finishes				
A	Pointing to all External wall surfaces with cement sand mortar 1:2	SM	65.00		
B	Apply plastering to internal wall surfaces, mortar mixer 2:1 (cement sand) mixed in waterproofing cement/admixture	SM	65.00		

C	Cement wash to external wall surface	SM	65.00		
D	Provide 3 coats of bituminous paint to all exposed concreted faces	SM	72.00		
E	Bondex Joint to masonry walling	SM	55.00		
F	Apply undercoat to external walling Ditto cream paint	SM	65.00		
G	Apply Bermuda blue paint 600mm from bottom of tank and 600mm from top of tank	SM	65.00		
	Carried to Collection				
4.7	Element No.7: Miscellaneous				
A	Provide 2No Vent pipes using 50mm GI pipes	No.	2.00		
B	Allow for 450 X 450mm Access on roof slab	No.	1.00		
C	Provide and install 75mm wide roof access ladder proper secured to the tank wall as directed	M	13.00		
D	Provides heavy duty lockable manhole cover to roof slab access chamber	No.	1.00		
E	Provide material and construct masonry chamber 1.0 X1.0 X1.2m	No.	2.00		
	Carried to Collection				
	SUMMARY				
4.1	EXCAVATION AND EARTHWORKS				
4.2	MASONRY WORK				
4.3	CONCRETE WORK				
4.4	CONCRETE ANCILLARIES				
4.5	PIPES AND FITTINGS				
4.6	FINISHES				
4.7	MISCELLANEOUS				
4.8	ALLOW FOR 25% TRANSPORTATION				
	TOTAL COST FOR 50M3 MASONRY TANK				
5	BILL NO. 5 CONSTRUCTION OF 1 WATER KIOSK				
5.1	Excavation and Earthworks				
A	Excavation and Earthworks -General excavation to remove top soil to an average depth of 250mm	SM	7		
B	Excavation for wall footing depth not exceeding 1200mm deep	CM	8		
C	Ditto to column bases	CM	2		
D	Excavation for front to back area depth not exceeding 250mm	CM	3		
E	Backfill and ram	CM	3		
F	Cart away surplus excavated material and deposit at recommended area.	CM	3		
G	300mm thick approved hardcore, well compacted in layers not exceeding 150mm and blinded using 50mm murrum/ quarry dust	SM	10		
H	Gauge 1000 polythene Damp proof and 50mm murram blinding	SM	15		
5.2	Masonry Work				
A	200mm thick natural stone walling to substructures in 1:3 sand/cement mortar. Rate to include hoop iron reinforcement at every course.	SM	10		
B	200mm thick natural stone walling to superstructures in 1:3 sand/cement mortar. Rate to include hoop iron reinforcement at every course.	SM	22		
C	200mm wide ventilation	PC	2		

D	150mm wide DPM to walls	SM	3		
5.3	Concrete Work				
A	Concrete grade 20/20 - 300 mm thick Plinth	CM	0.2		
B	Concrete grade 20/20 - 100mm thick slanting front area	CM	0.3		
C	Reinforced concrete grade 20/25 - 100mm thick floor slab	CM	0.6		
D	Reinforced concrete grade 20/20 - 150mm thick roof	CM	1		
E	Reinforced concrete grade 20/20 to strip footing	CM	1.2		
F	Reinforced concrete grade 20/25 to column base	CM	3		
G	Reinforced concrete grade 20/25 to columns	CM	0.5		
H	Reinforced concrete grade 20/25 to beam	CM	1.0		
5.4	Concrete Ancillaries				
A	Sawn formwork to Sides of strip footing	SM	5		
B	Sawn formwork to Edges ground slab 100mm wide	LM	19		
C	Sawn formwork to sides and Soffits of 300mm deep plinth and slanting front area	SM	2		
D	Sawn formwork to edges of roof slab	LM	12		
E	Sawn formwork to Underneath roof slab, including props	SM	8		
F	Sawn formwork sides and soffits of beam 300mm deep	SM	6		
G	A142 mild steel reinforcement	SM	15		
H	8mm reinforcement bars	KG	82		
I	10mm reinforcement bars	KG	54		
J	12mm reinforcement bars	KG	93		
5.5	Doors and Windows				
A	1000x2000mm steel door including locks and hinges to details	No.	1		
B	950x1000mm steel swing window including locks and hinges to details	No.	1		
C	Built in table with two lockable drawers	No.	1		
D	Meter Box 220x220x300mm Lockable	No.	1		
5.6	Pipe and Fittings				
	<u>All pipes to be galvanised iron with threads</u>	-	-		
A	32mm outlet pipe	M	12		
B	32mmdia. Elbows	No.	8		
C	32 mm dia. Valve sockets	No.	2		
D	32mm dia. Gate Valve as Peglar	No.	1		
E	32x32mm Tee	No.	3		
F	32x20mm reducing bush	No.	2		
G	32mm end Plug	No.	2		
H	32mm union	No.	2		
I	32mm short nipple	No.	2		
J	20mm union	No.	4		
K	20mm barrel nipple	No.	4		
L	20mm ball valve	No.	4		
M	20mm elbow	No.	12		
N	32mm Peglar or approved Water Meter	No.	1		
O	20mm taps	No.	4		
P	Sundries and Installation labour for the above fittings	No.	1		
5.7	Finishes				
	Plastering to all masonry and concrete surfaces(internally and externally)	SM	32		
A	Provide three coats of gloss piant to all plastered surfaces	SM	32		

5.8	Drainage and Water Supply				
	<i>Catch pit</i>				
A	Excavate for 400mm squarex700mm catch pit to detail	CM	0.2		
B	100mm thick block lining to the sides of the catch pit	SM	2		
C	100mm thick mass concrete for catch pit base slab	CM	0.1		
D	20mm thick plaster mixed with Sika or equivalent water proofing admixture to walls surfaces internally.	SM	2		
E	Catch pit grating made from wielded sections to form 25mm square mesh on 50mm steel frame.	ITEM	1		
	<i>Soak pit</i>				
A	Prepare site by stripping top 150mm of soil to remove all debris including sand (if any) from site and carting away spoil	SM	1		
B	Pit excavation commencing at reduced levels depth not exceeding 1.50m deep.	CM	1.5		
C	Ditto 1.50 - 3.00 metres deep	CM	1.5		
D	Remove surplus excavated material from site	CM	3		
E	Graded approved free draining hard-core/ rubble stone filling the soak pit	CM	1		
F	100mm thick cover slab	CM	0.2		
G	10mm reinforcement bars	KG	13		
H	Sawn formwork to sides and soffits of slab	SM	1.4		
I	Provide and install 200mm Drainage PVC pipe for inlet and outlet connections including adjoining fittings	LM	10		
	<i>Plastic Tank</i>				
A	Provide and install 5000L approved plastic tank on top of the kiosk roof complete with all fitting (its nipples, back nuts and float/ball valve) and associated piping.	No.	1		
B	Provide for branding with IRK Logo and wording as directed by the Engineer on plastic tank and water Kiosk.	ITEM	1		
	TOTAL FOR WATER KIOSK CARRIED TO GRAND SUMMARY				
6	BILL NO.6: CONSTRUCTION OF 1No. 12M LONG CATTLE TROUGHS				
6.1	Earthworks				
6.1.1	Prepare site by stripping top 150 mm of soil to remove all debris including sand (if any) from site and carting away spoil	SM	81		
6.1.2	Excavate for foundation strip commencing at stripped levels depth not exceeding 1.50m deep	CM	25		
6.1.3	Remove surplus excavated material from site	CM	25		
6.1.4	Backfill around foundation	CM	10		
6.2	Filling				
6.2.1	200 mm thick approved hardcore filling spread, well rammed and compacted in 150mm layers to receive concrete surface bed	CM	8		
6.3	Concrete work				
	<i>Mass Concrete class 15 (1:3:6) with 20mm thick maximum aggregate size in</i>				
6.3.1	50mm blinding layer on hardcore surfaces	SM	38		
	<i>Vibrated reinforced concrete class 25 (1:1.5:3) with 20mm maximum aggregate as described in:</i>				
6.3.2	Strip foundation	CM	2		

6.3.3	75mm thick concrete benching laid to falls and with surface steel trowelled rough (Optional)	CM	4.5		
6.3.4	100 mm thick floor slab	CM	2		
6.4	Reinforcement				
6.4.1	Mesh fabric reinforcement ref. No. A142 laid in floor slab with minimum 150 mm side allowance	SM	20		
6.5	Finishes				
	<i>Cement and sand mortar (1:3) in:</i>				
6.5.1	12 mm Thick paving to floor with water proof cement (Optional)	SM	10		
6.5.2	15mm thick plaster to internal side of wall with water proofcement	SM	14		
6.6	Blockwork and Masonry				
	<i>To include supply and lay dressed building stones for masonry walls</i>				
6.6.1	225mm thick ashlar masonry, vertical straight walls; thickness 150-250	SM	27		
6.7	Galvanized mild steel pipes class "B" medium thickness with and including jointing fittings and fixed as described				
6.7.1	32mm diameter inlet pipe chased through masonry wall 300 mm long with and including stop cork (Float Valve)	NO	1		
6.7.2	Provide and install 32mm diameter inlet pipe c/w gate valve, 2No. hex nipple, 2No.elbow and 2No.unions.	M	6		
6.7.3	Construct Lockable steel cover and attach to valve chamber at water trough complete with control gate valves and adjoining fittings.	No.	1		
	TOTAL FOR 1 WATER TROUGH				
7	BILL No. 7: PIPING TO MASONRY TANK, CATTLE TROUGH AND KIOSK				
7.1	Connection between elevated borehole water steel tank piping at older masonry tank and valve chamber				
A	Excavate and backfill pipeline trench (after laying of pipe) 450mm wide and between 0.6m and 1.5m deep.	M	25		
B	Provide and lay HDPE pipe PN 6 DN 63 delivery line from elevated borehole water steel tank to valve chamber c/w assorted fittings and other accessories	M	25		
7.2	Connection between masonry and cattle trough				
A	Excavate and backfill pipeline trench (after laying of pipe) 450mm wide and between 0.6m and 1.5m deep. Cost to include excavations in rocky formations.	M	80		
B	Provide and lay HDPE pipe PN 6 DN 63 delivery line from masonry to cattle trough c/w assorted fittings, non return valve and other accessories	M	80		
7.3	Connection between masonry tank and valve chamber				
A	Excavate and backfill pipeline trench (after laying of pipe) 450mm wide and between 0.6m and 1.5m deep.	M	15		
B	Provide and lay HDPE pipe PN 6 DN 63 delivery line from masonry tank to valve chamber c/w assorted fittings, non return valve and other accessories	M	15		
7.4	Connection between valve chamber to water kiosk				
A	Excavate and backfill pipeline trench (after laying of pipe) 450mm wide and between 0.6m and 1.5m deep. Cost to include excavations in rocky formations.	M	80		
B	Provide and lay HDPE pipe PN 6 DN 63 delivery line from valve chamber to water kiosk c/w assorted fittings, non return valve and other accessories	M	80		

C	Construct 1000 x 1000 x700 Valve Chambers with Lockable steel cover 2m away from fence complete with control gate valves and adjoining fittings to isolate the water kiosk and trough lines.	No.	1		
D	Allow for contingencies, commissioning and testing to full operationalization of the tank and piping for use by the community.	LS	1		
	TOTAL CARRIED FOR PIPING TO WATER KIOSK AND TROUGH TO MAIN SUMMARY				
	GRAND SUMMARY OF PROJECT COMPONENTS				
BILL NO.	DESCRIPTION				
1	CLEARING OF COMPOUND AND PAINTING OF POWER CONTROL HOUSE				
2	REPAIR OF EXISTING ELEVATED TANK				
3	RENOVATION OF 1No. LATRINE AND BATHROOM				
4	CONSTRUCTION OF 50M ³ MASONRY TANK				
5	CONSTRUCTION OF 1 WATER KIOSK				
6	CONSTRUCTION OF 12M LONG WATER TROUGH				
7	PIPING TO WATER KIOSK AND TROUGH FROM BOREHOLE COMPOUND				
	Sub-Total				
	Add VAT 16%				
	TOTAL FOR REHABILITATION OF BUKUMA WATER SUPPLY PROJECT IN WAJIR WEST SUB COUNTY, WAJIR COUNTY				

ANNEX II: DRAWINGS

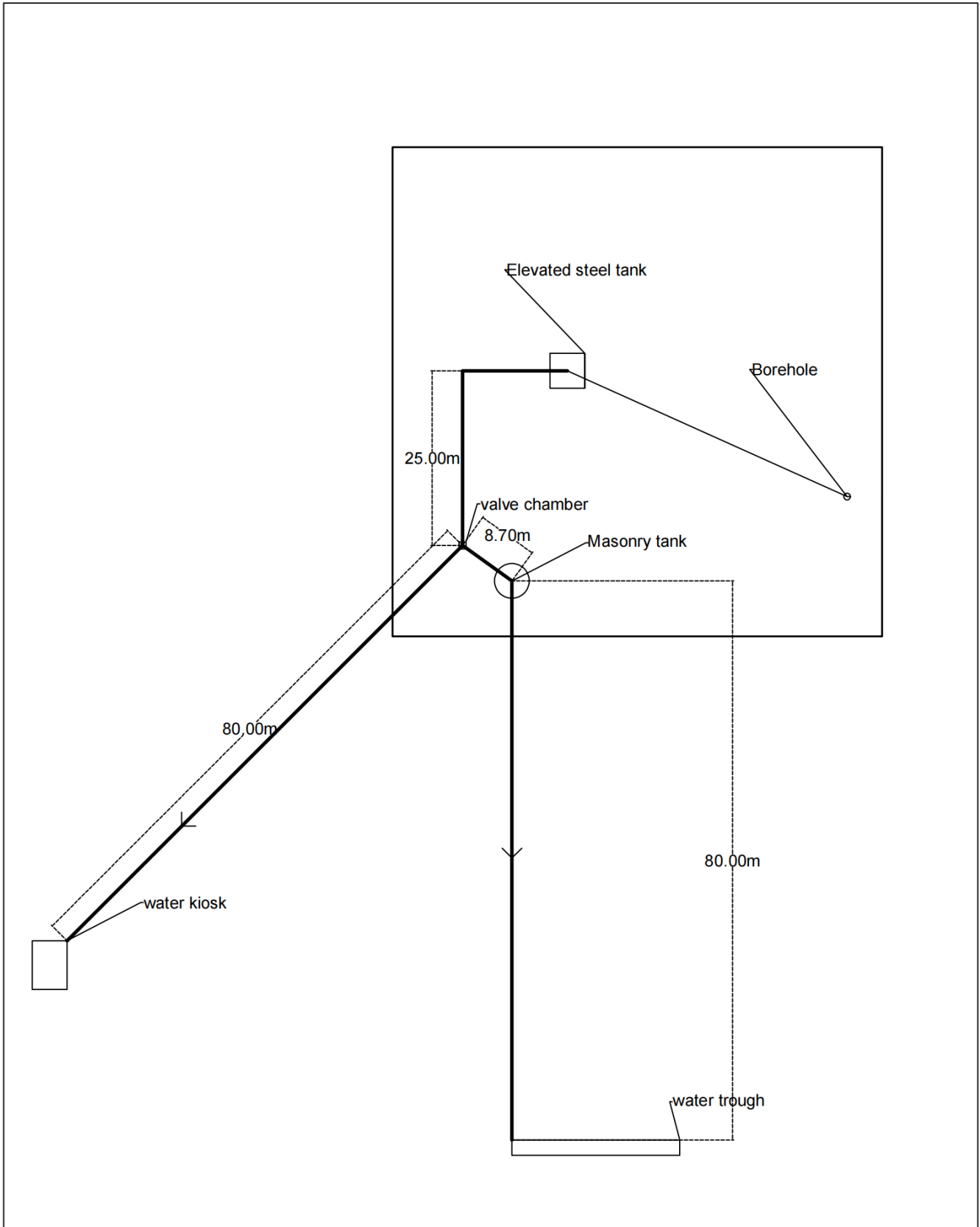

CLIENT: ISLAMIC RELIEF	DRAWING: BUKUMA BOREHOLE AREA LAYOUT	DRAWN: PATRICK N
PROJECT: BRACC	SCALE: 1:700	DATE: 1/11/2024

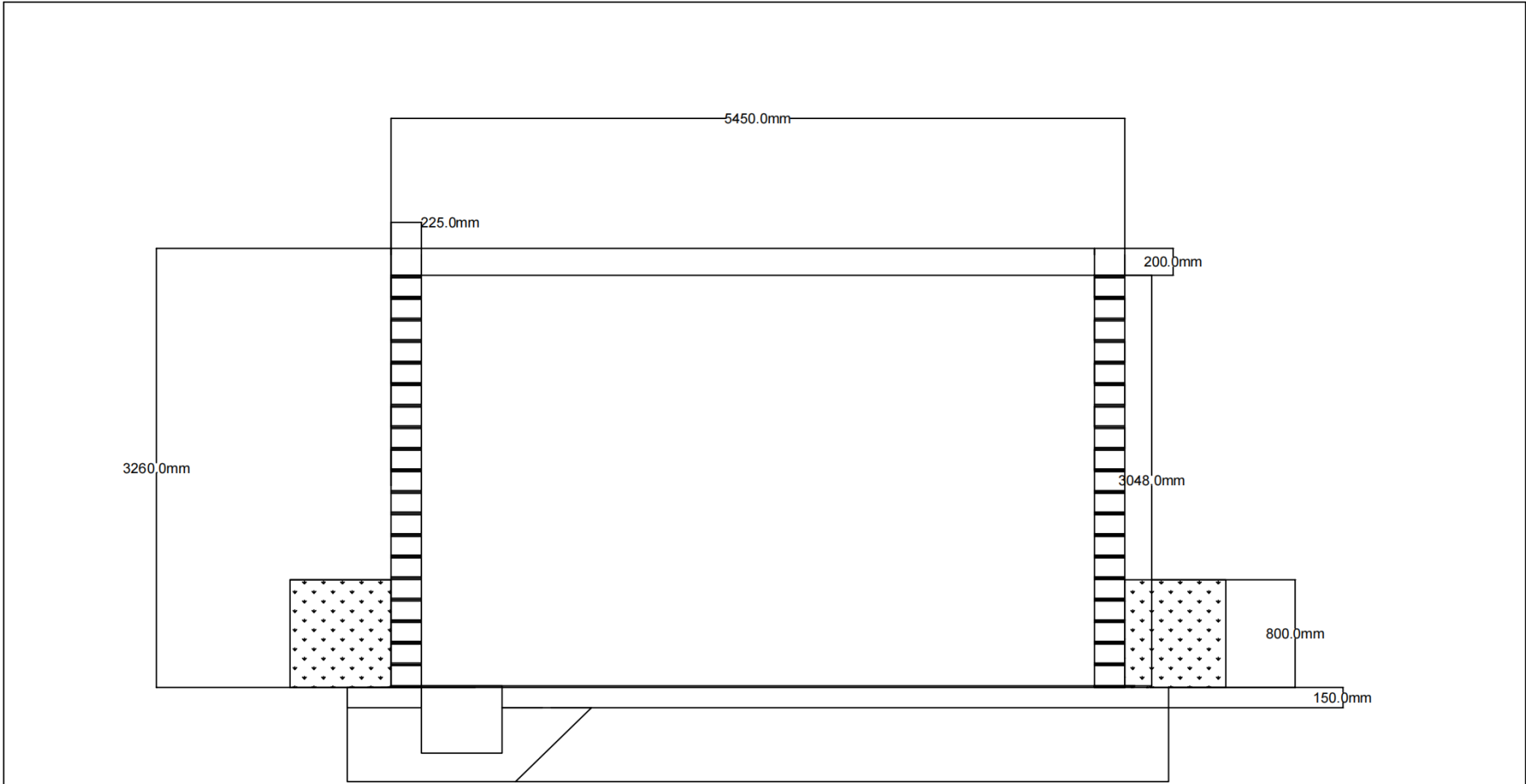

CLIENT: ISLAMIC RELIEF	PROJECT: BRACC	DRAWING: 50 CUBIC MASONRY TANK	SCALE: 1:40	DRAWN BY: PATRICK N	DATE: 1/11/24
------------------------	-------------------	-----------------------------------	-------------	---------------------	---------------

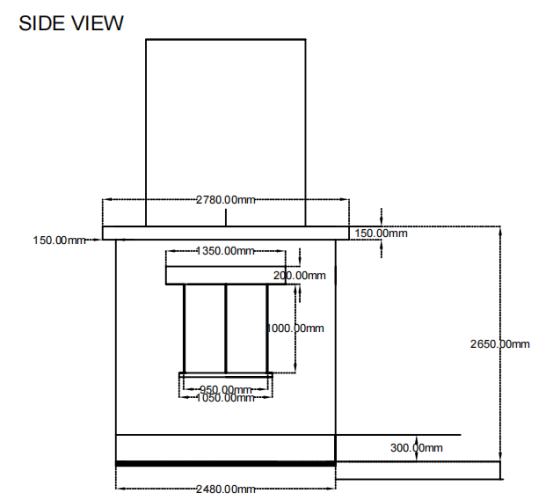
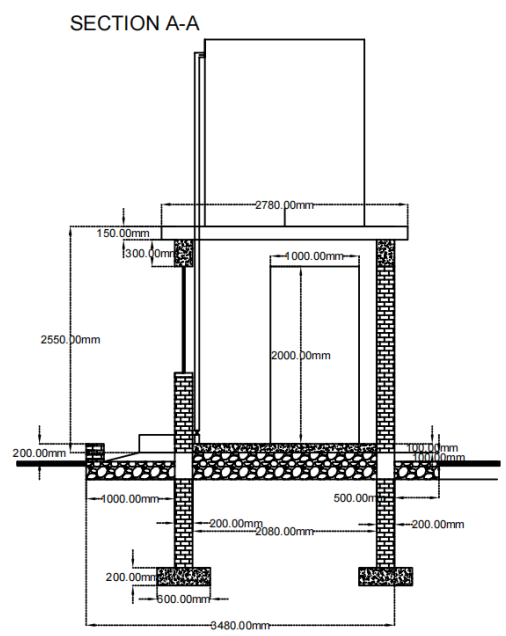
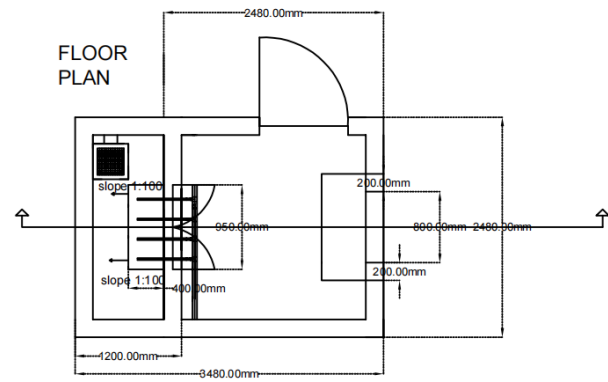

CLIENT: ISLAMIC RELIEF	PROJECT: BRACC	DRAWING: WATER KIOSK	SCALE: 1:75	DRAWIN BY: PATRICK N	DATE: 22ND OCTOBER
------------------------	-------------------	----------------------	-------------	-------------------------	--------------------

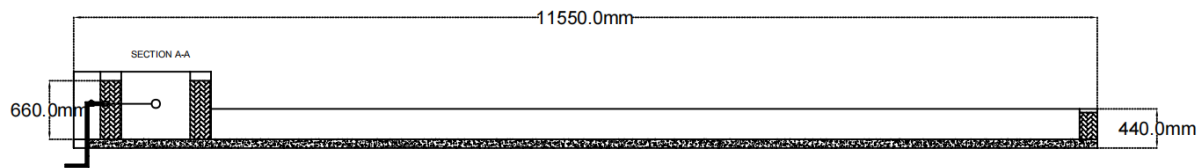
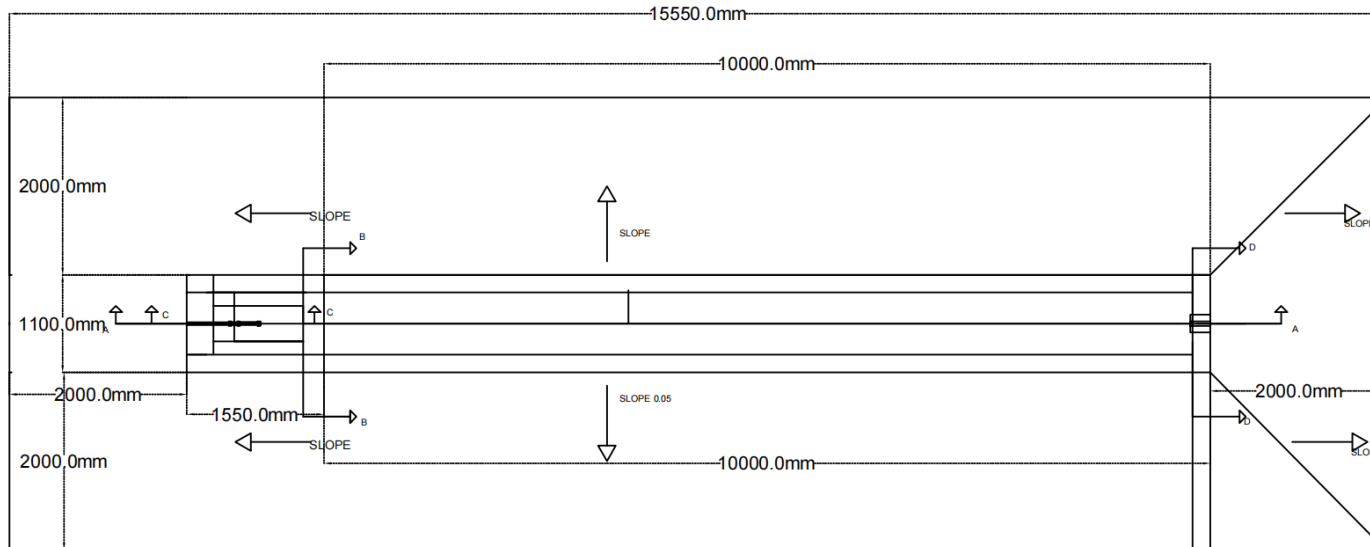

CLIENT: ISLAMIC RELIEF	PROJECT: BRACC	DRAWING: WATER TROUGH	SCALE: 1:75	DRAWN BY: PATRICK N	DATE: 14th OCTOBER 2024
------------------------	----------------	-----------------------	-------------	---------------------	-------------------------

